

50
Enduro
cm³

50
Supermotard
cm³

Spare part's book

>MOTO

SHERCO-50 .02 series



SHERCO
Motorcycles

SOMMAIRE

	PAGE					
CADRE	1					
FOURCHE	2					
AMORTISSEUR	3					
BRAS OSCILLANT	4					
FREIN AVANT	5					
FREIN ARRIERE	6					
SYSTEME D'ECHAPPEMENT	7					
RESERVOIR D'ESSENCE	8					
RADIATEUR ET RESERVOIR D'HUILE	9					
BOITE FILTRE A AIR	10					
ÉLEMENTS ELECTRIQUES	11					
ECLAIRAGE	12					
COMPTEUR	13					
ROUE AVANT	14 A 16					
ROUE ARRIÈRE	15 A 17					
GUIDON ET COMMANDE	18					
PLASTIQUES	19 A 20					
DECORATIONS	21					
SCHEMA ELECTRIQUE	22					
MOTEUR	23 et 24					

Rep
1
2
3
4
5
6
7
8
9
10
11
12
13
14
15
16
17
18
19
20
21
22
23
24
25
26
27
28
29
30
31
32

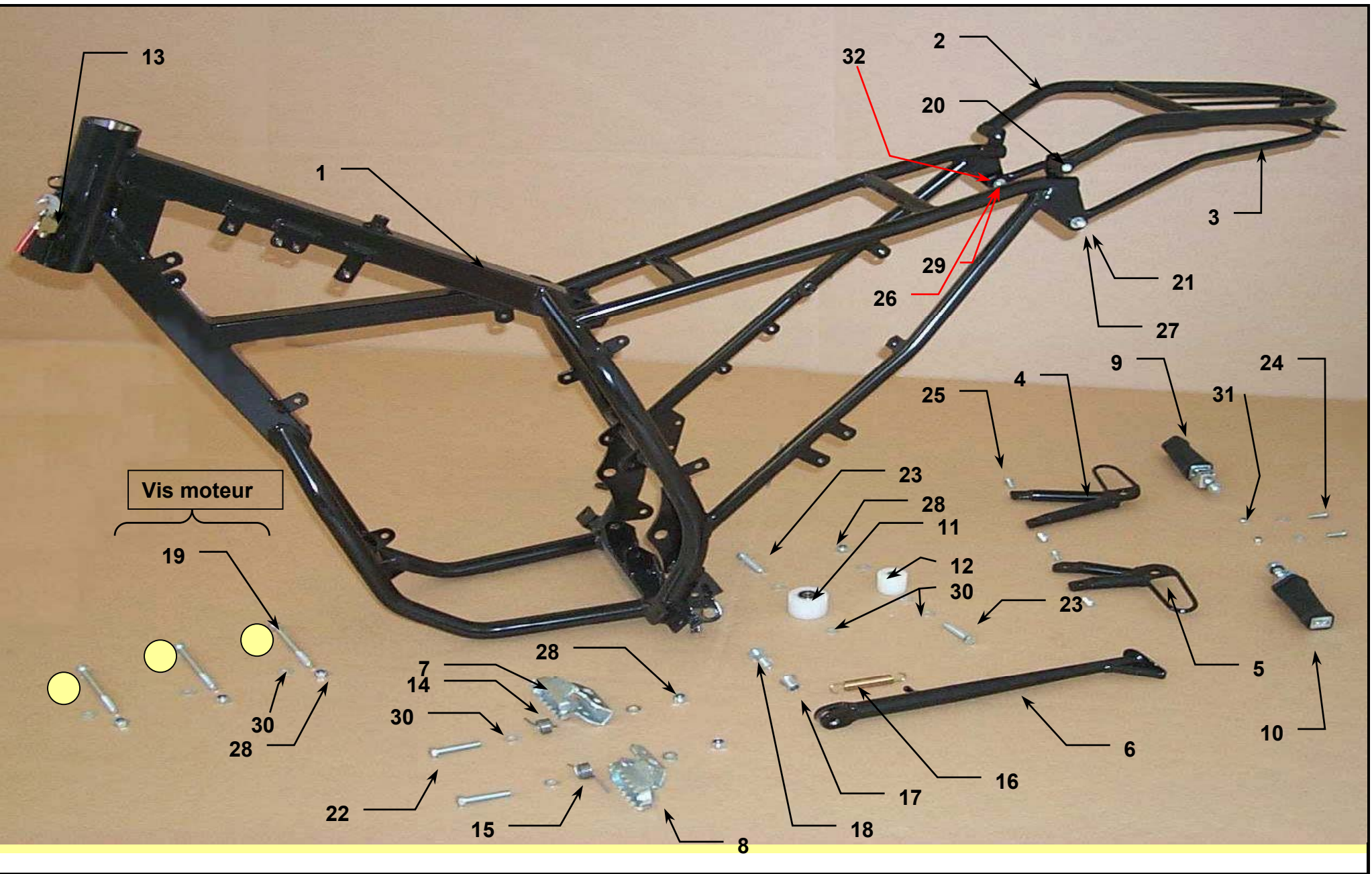

Rep

1

2

3

4

5

2

3

5

1

5

4

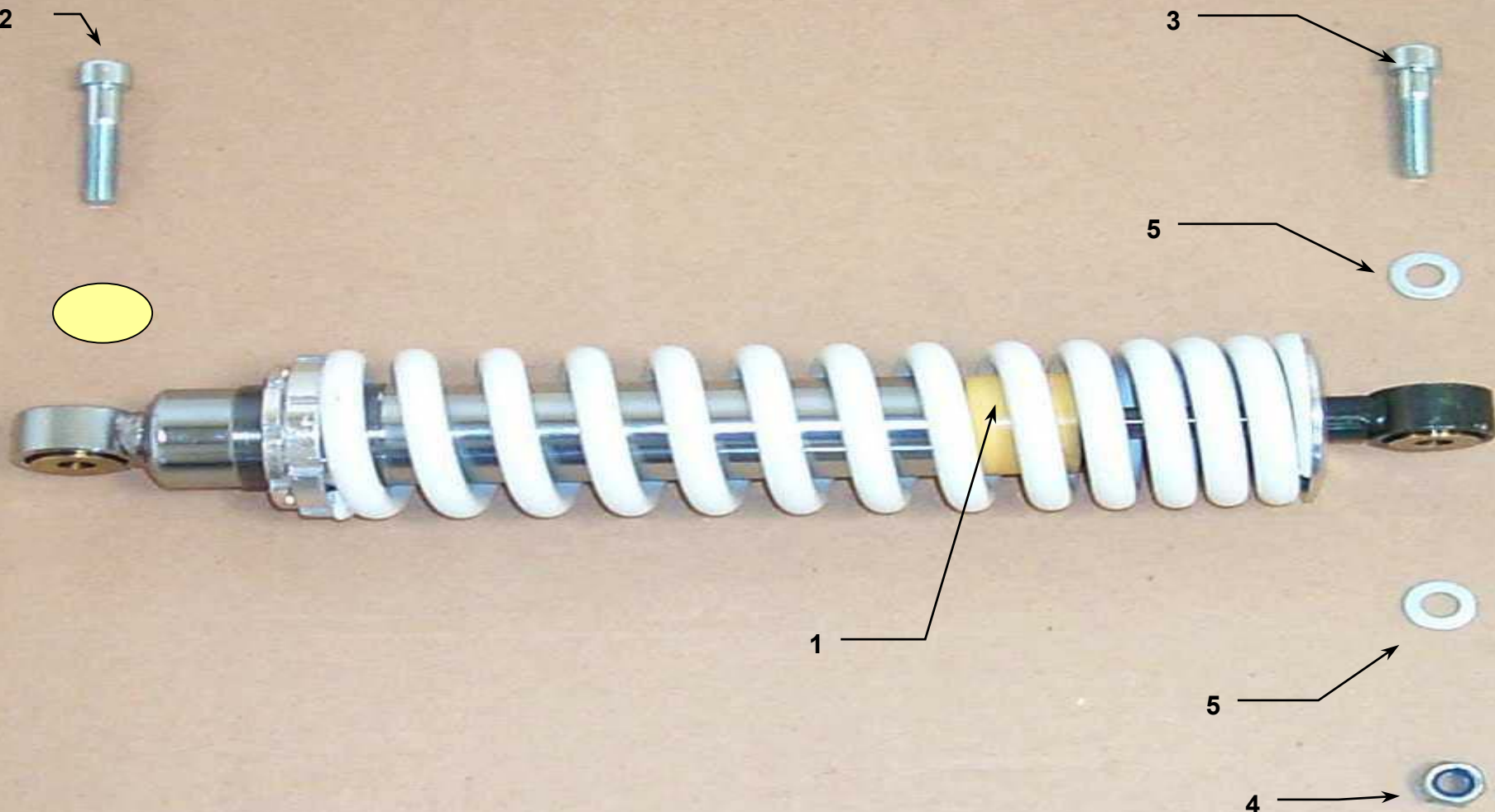

Rep

- 1
- 2
- 3
- 4
- 5
- 6
- 7
- 8
- 9
- 10
- 11
- 12
- 13
- 14
- 15

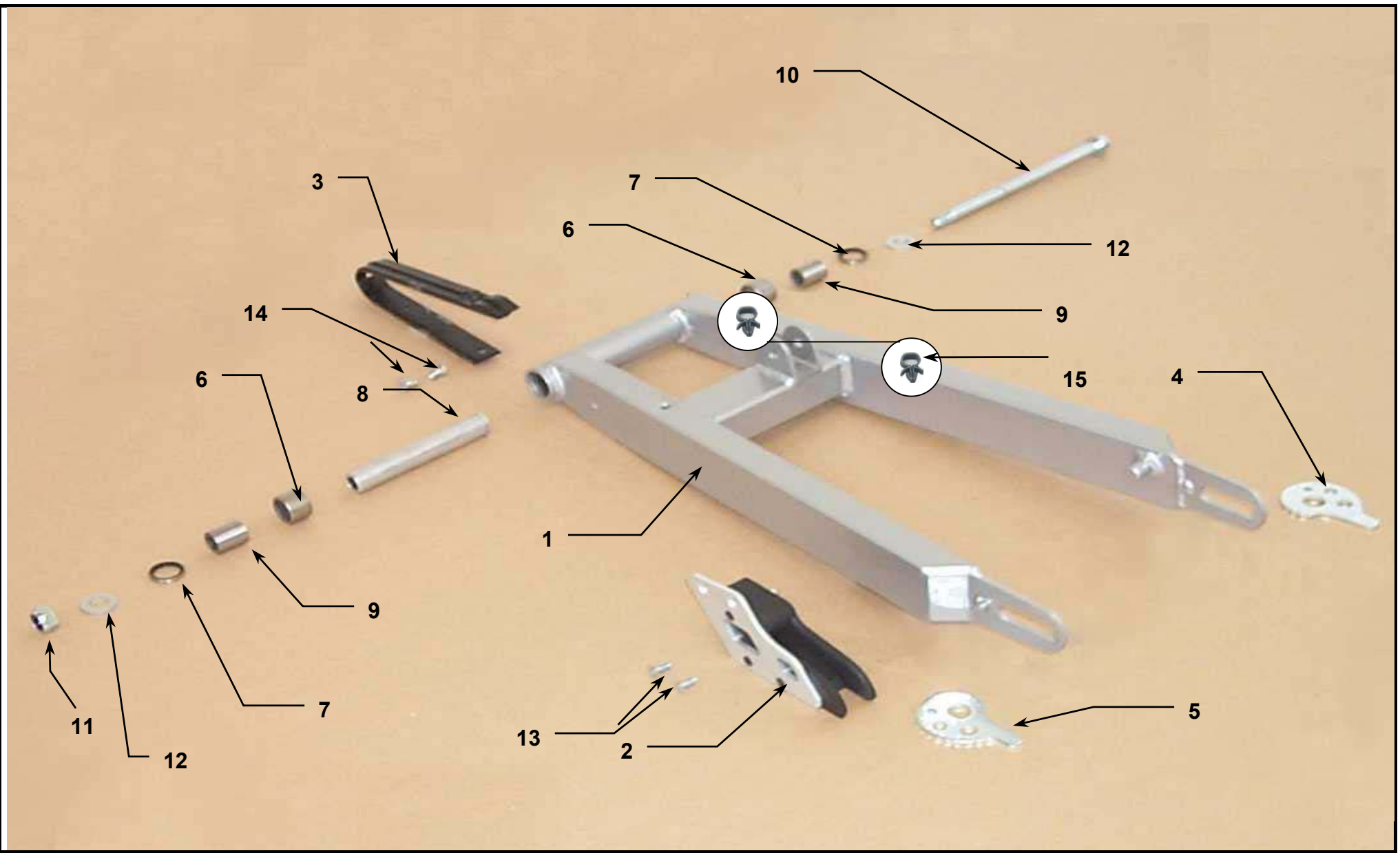

Rep

- 1
- 2
- 3
- 4
- 5
- 6
- 7
- 8
- 9
- 10
- 11
- 12
- 13
- 14

LA REF 14 COMPREND : 1 ; 2 ; 3 ; 4 ; 5 ; 6 ; 7 ;
8 ; 9 ; 10 ;

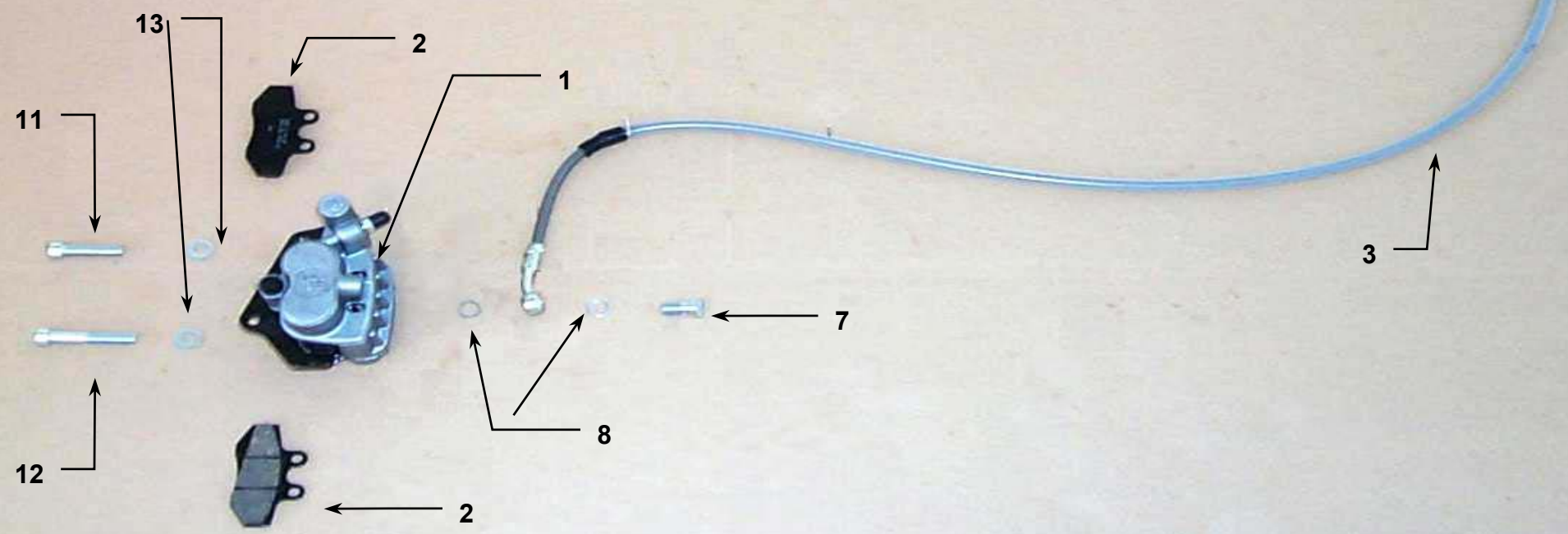
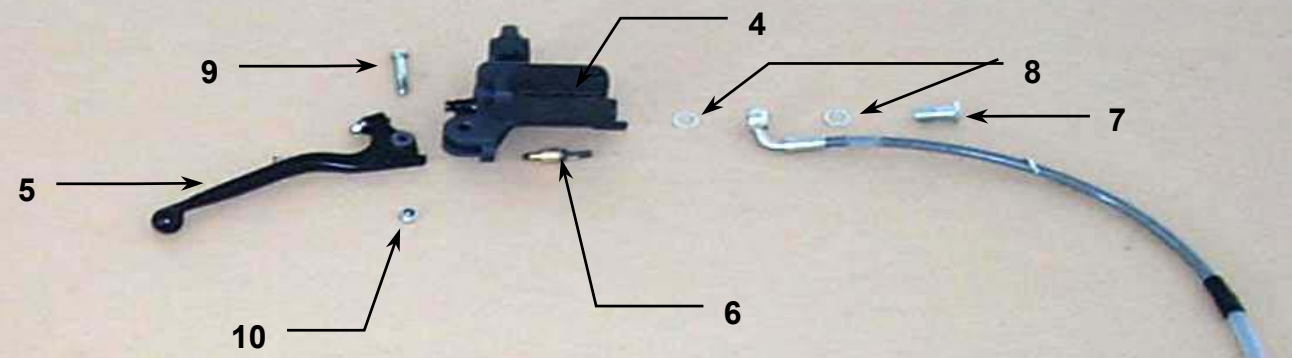

Rep

- 1
- 2
- 3
- 4
- 5
- 6
- 7
- 8
- 9
- 10
- 11
- 12
- 13
- 14
- 15
- 16
- 17
- 18
- 19
- 20
- 21
- 22
- 23
- 24

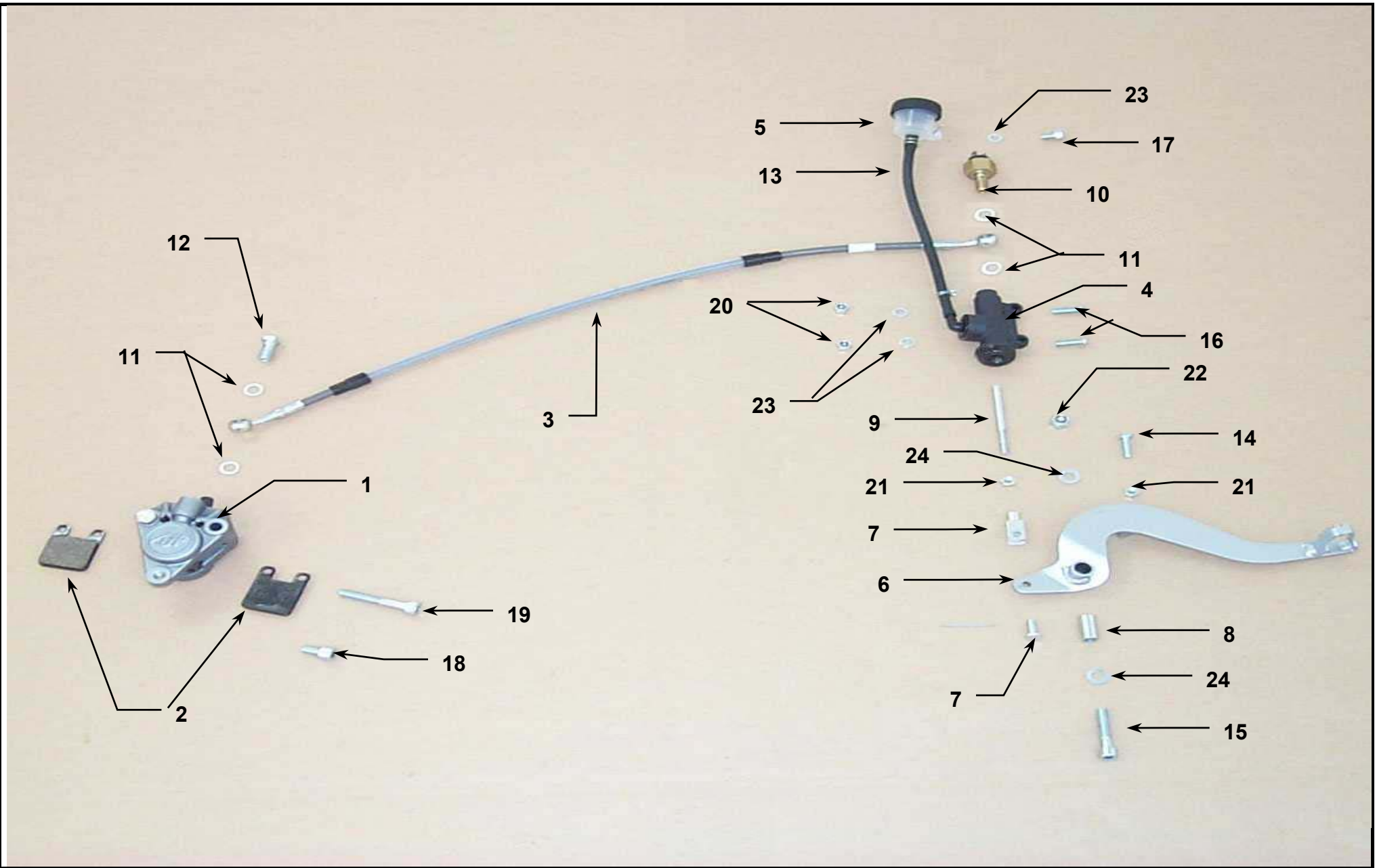

- Rep
- 1
- 2
- 3
- 4
- 5
- 6
- 7
- 8
- 9
- 10
- 11
- 12
- 13
- 14

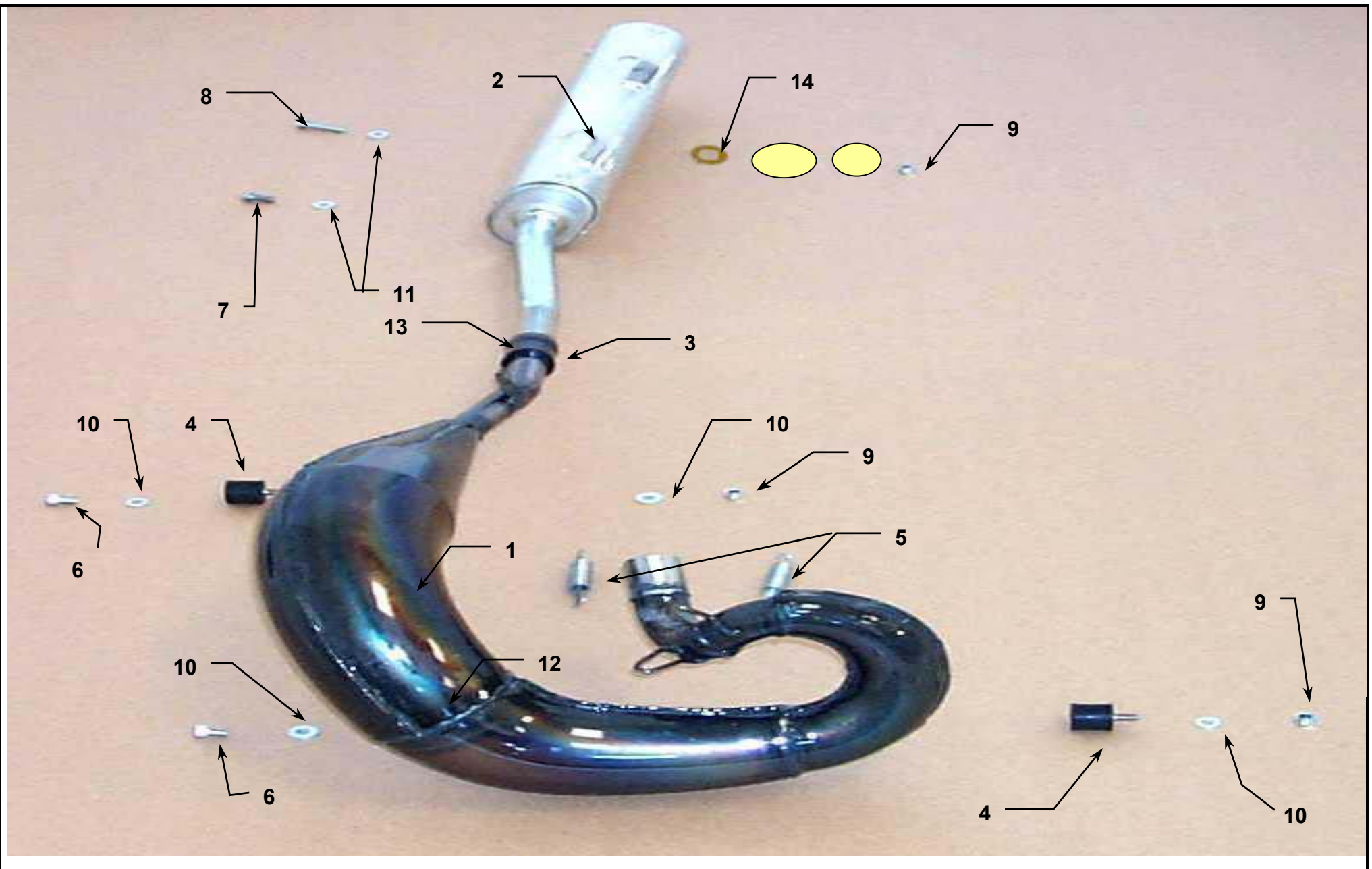

Rep

- 1
- 2
- 3
- 4
- 5
- 6
- 7
- 8
- 9
- 10

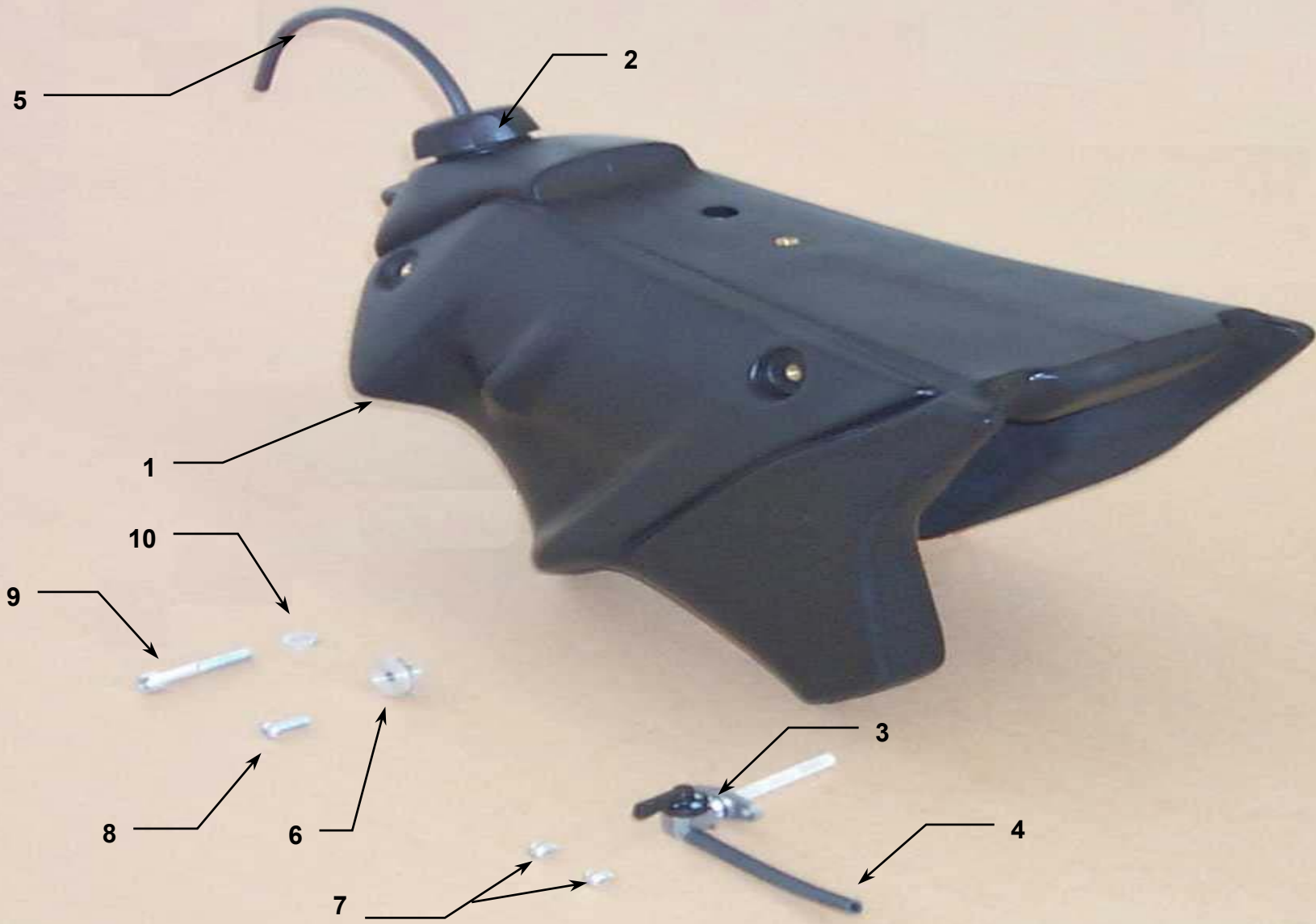

Rep

- 1
- 2
- 3
- 4
- 5
- 6
- 7
- 8
- 9
- 10

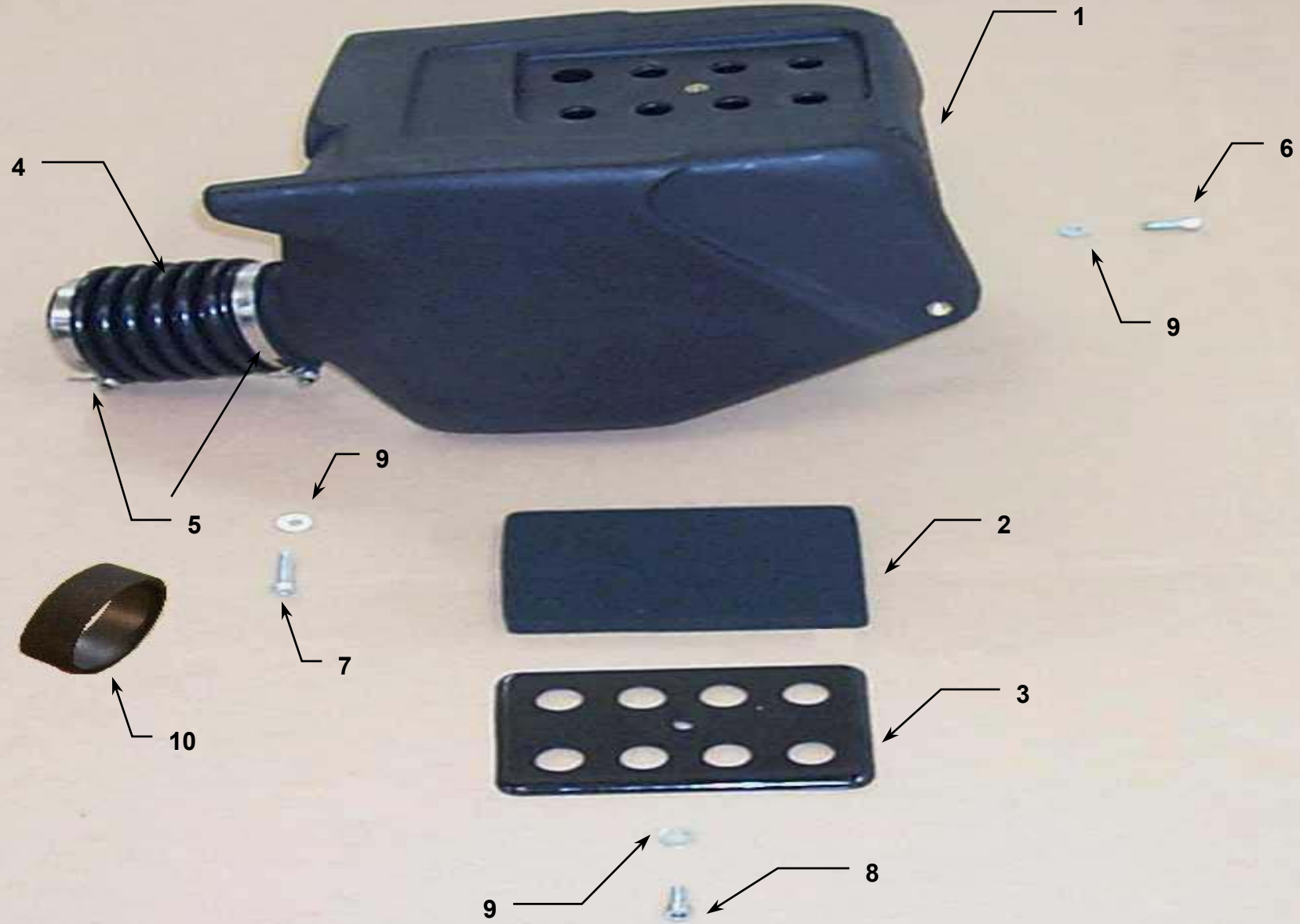

Rep
1
2
3
4
5
6
7
8
9
10
11
12
13

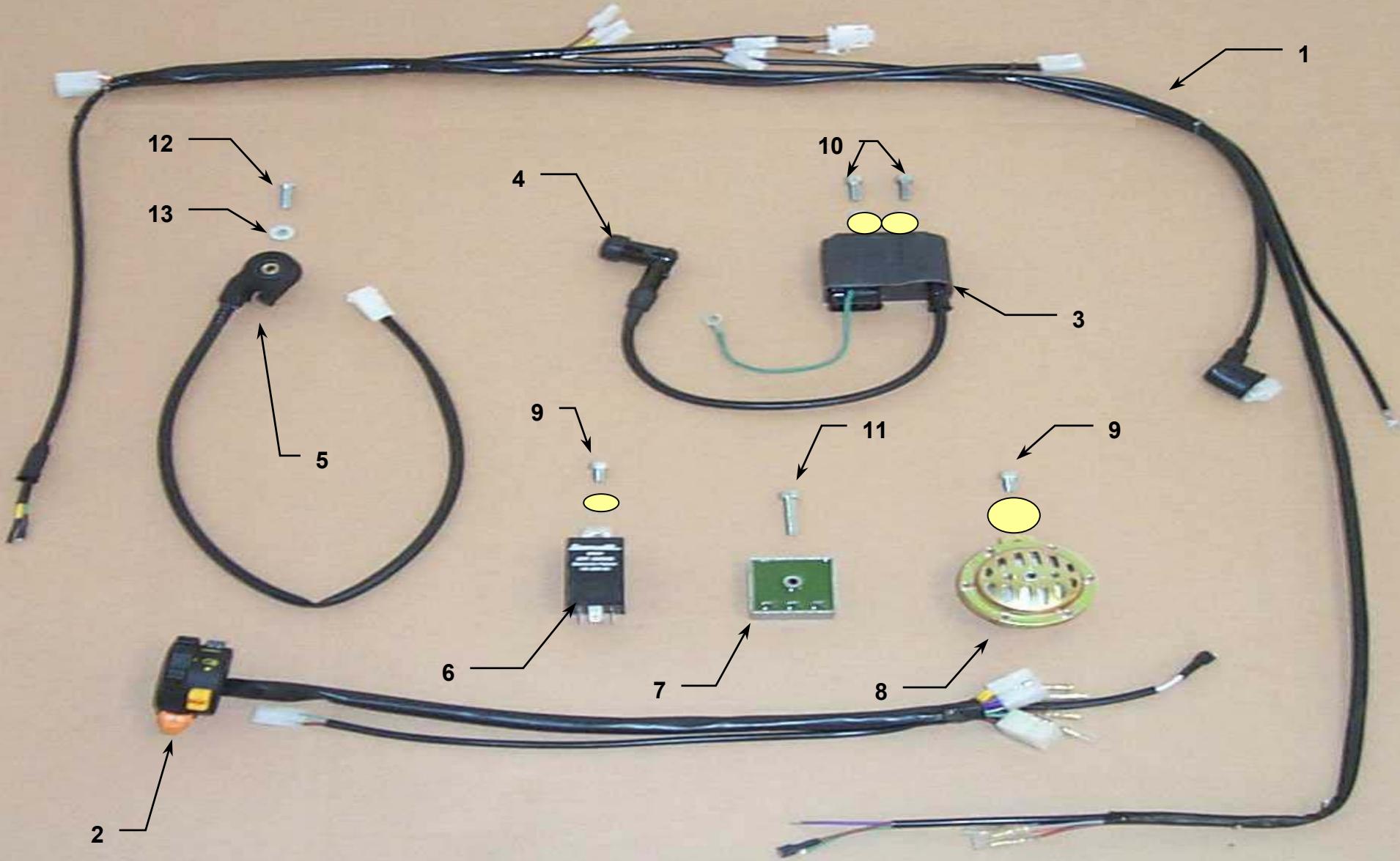

Rep
 1
 2
 3
 4
 5
 6
 7
 8
 9
 10
 11
 12
 13
 14
 15
 16
 17
 18

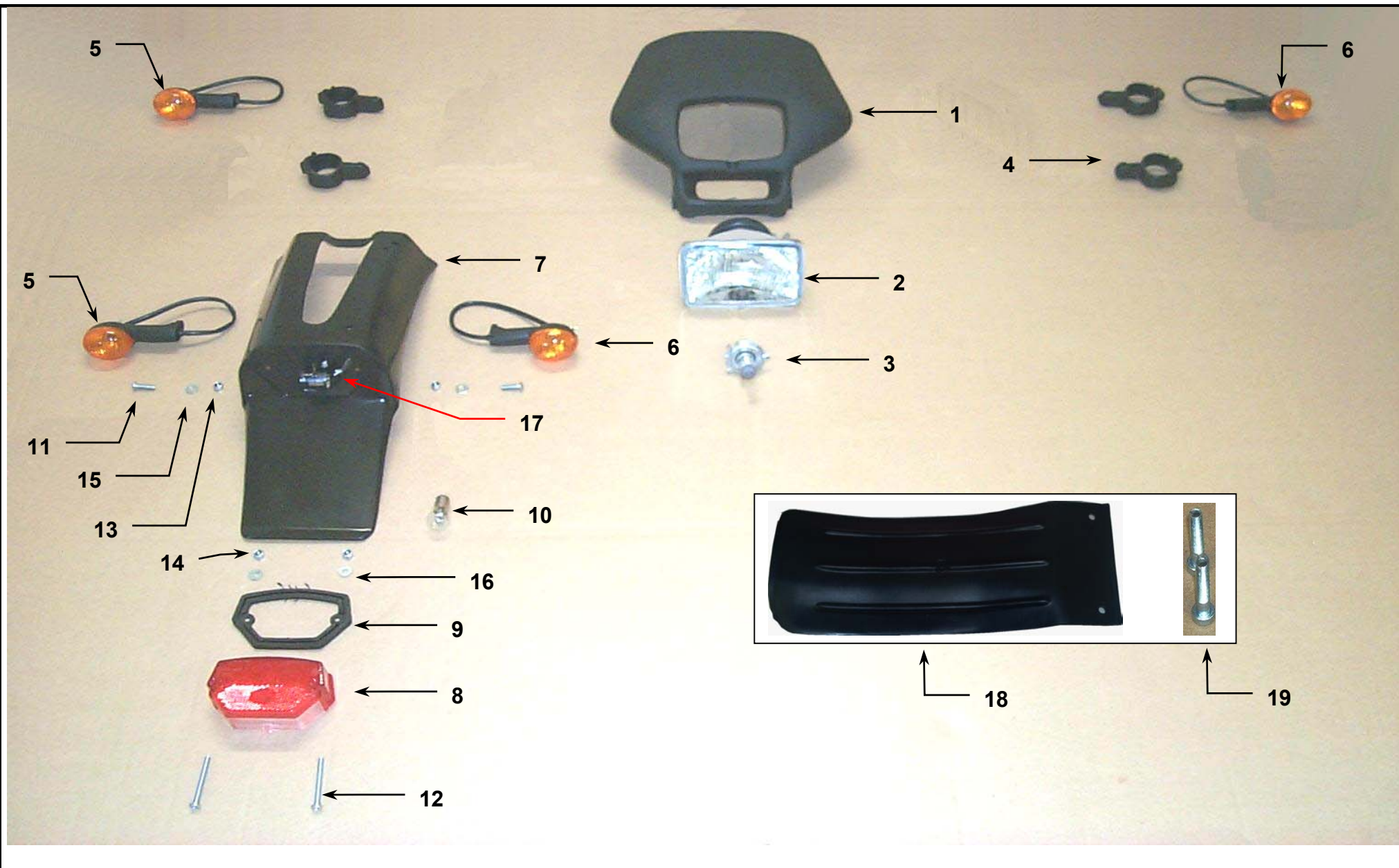

Rep

1

2

3

4

5

6

7

8

9

10

11

12

13

14

REF 2 =CHAMBRE
REF 3 = FOND DE JANTE
REF 6 = ECROU RAYON

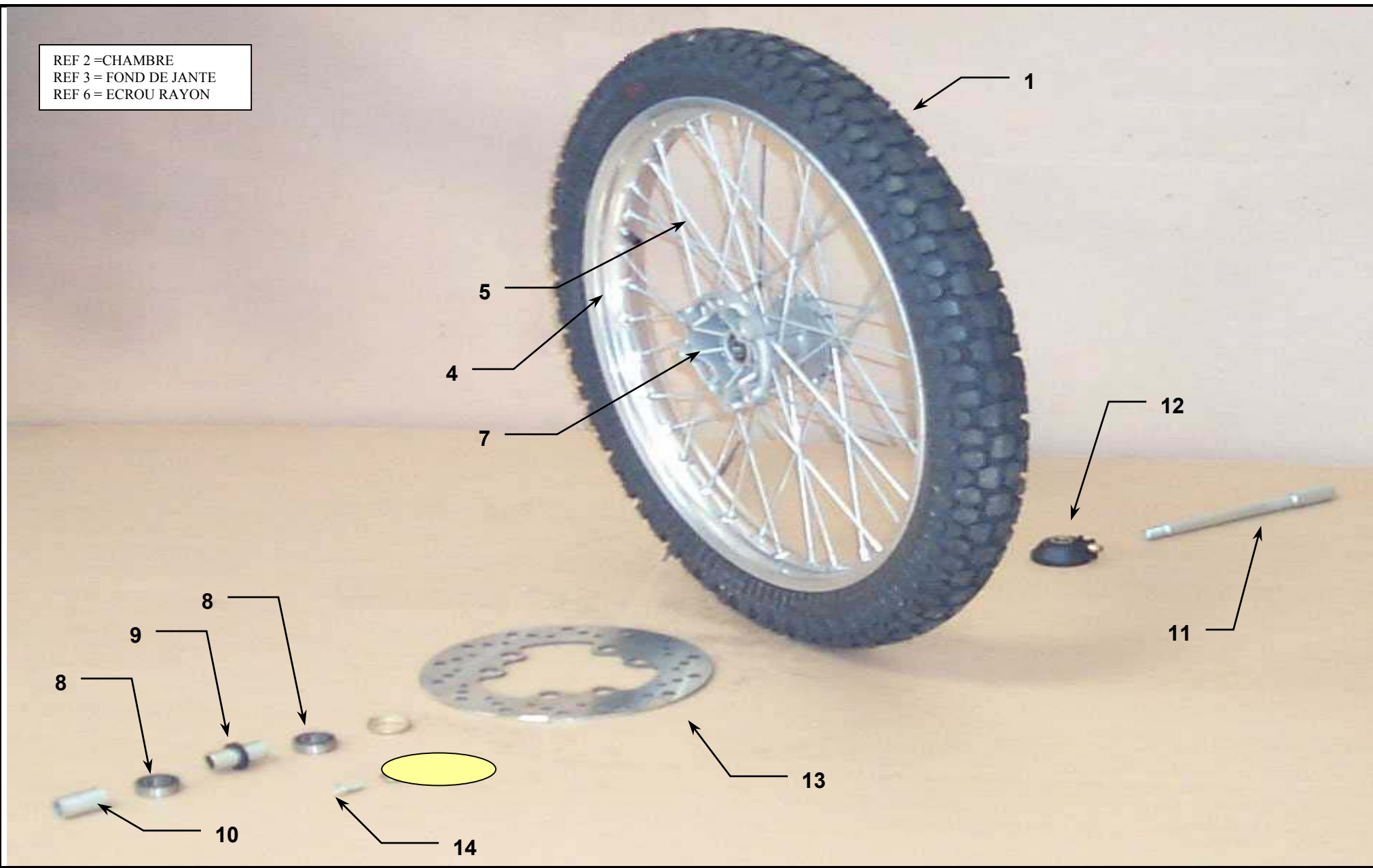

Rep
1
2
3
4
5
6
7
8
9
10
11
14
15
16
17
18
19

REF 2 =CHAMBRE
REF 3 = FOND DE JANTE
REF 6 = ECROU RAYON

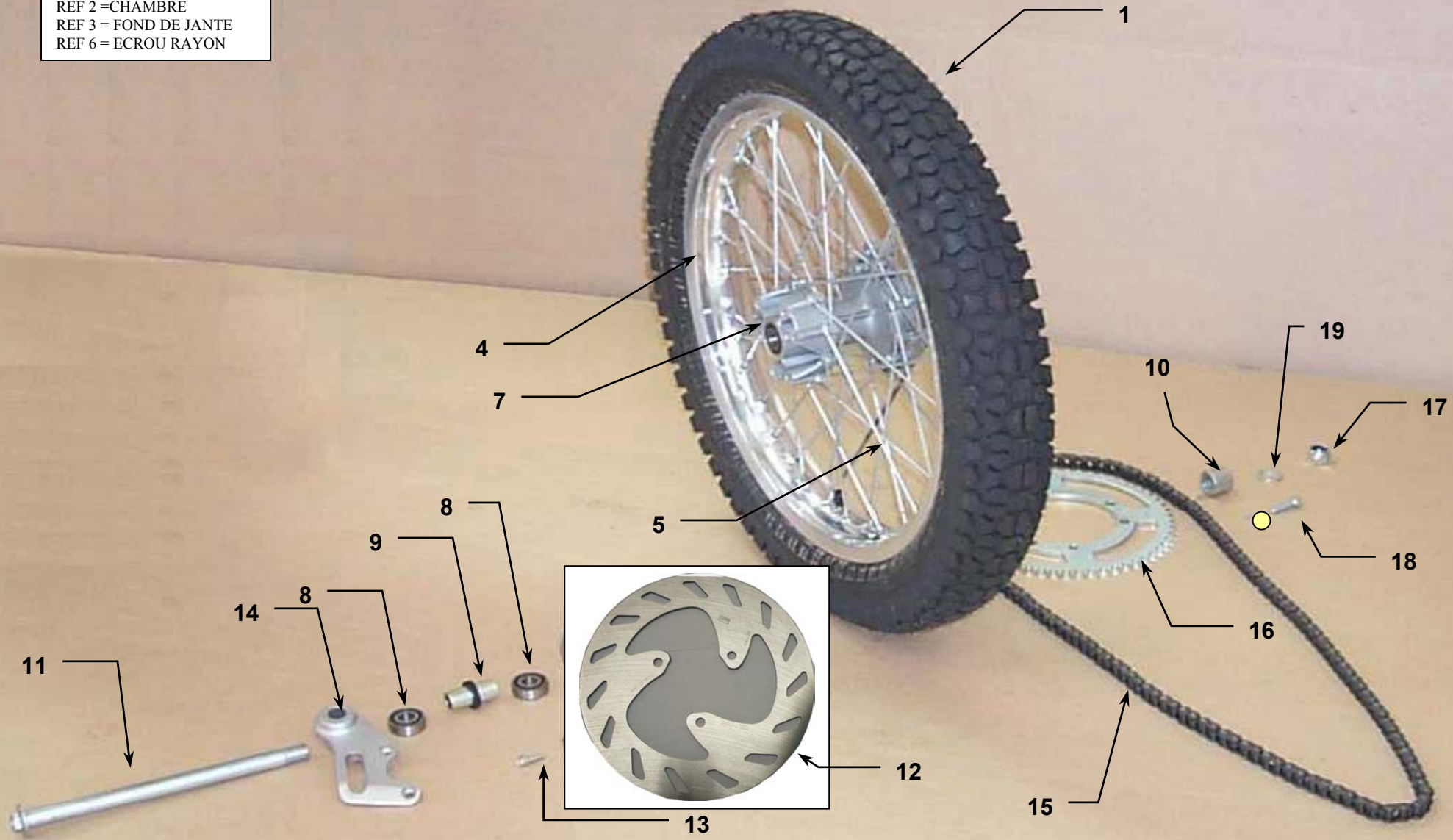

Rep

1

2

3

4

5

6

7

8

9

10

11

12

13

14

REF 2 =CHAMBRE
REF 3 = FOND DE JANTE
REF 6 = ECROU RAYON

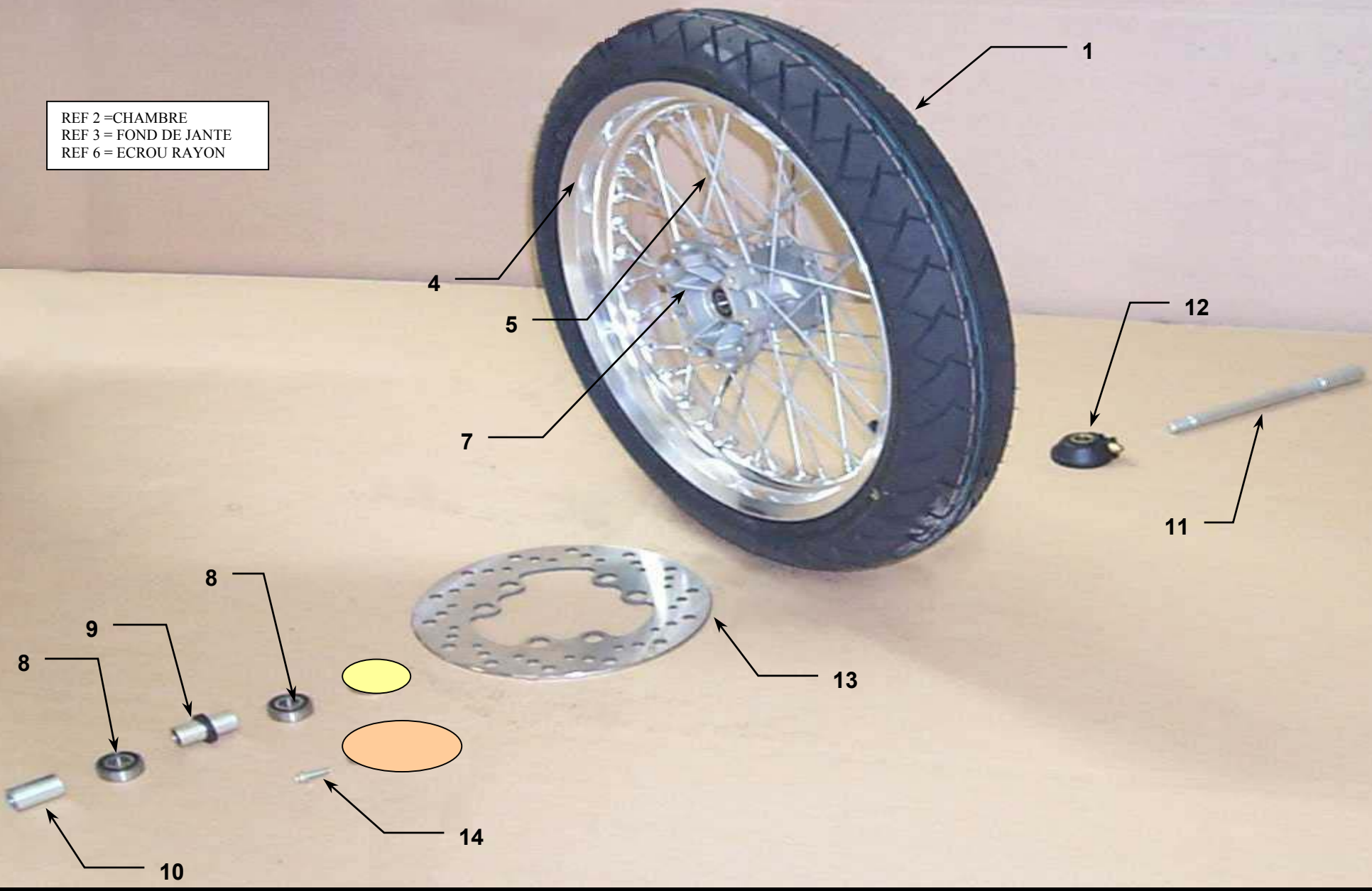

Rep

- 1
- 2
- 3
- 4
- 5
- 6
- 7
- 8
- 9
- 10
- 11
- 14
- 15
- 16
- 17
- 18
- 19

REF 2 = CHAMBRE
REF 3 = FOND DE JANTE
REF 6 = ECROU RAYON

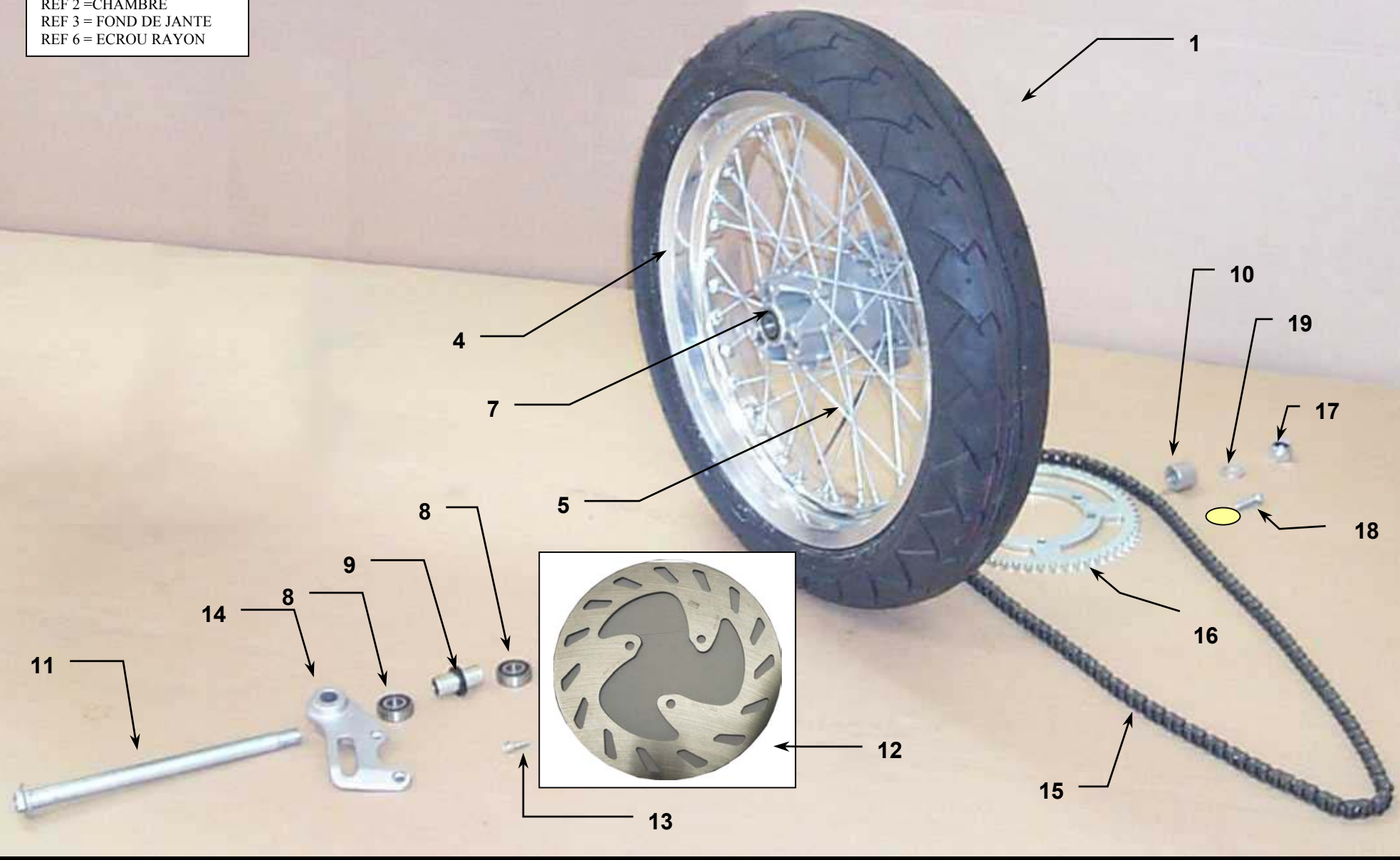

Rep

- 1
- 2
- 3
- 4
- 5
- 6
- 7
- 8
- 9
- 10
- 11
- 12
- 13

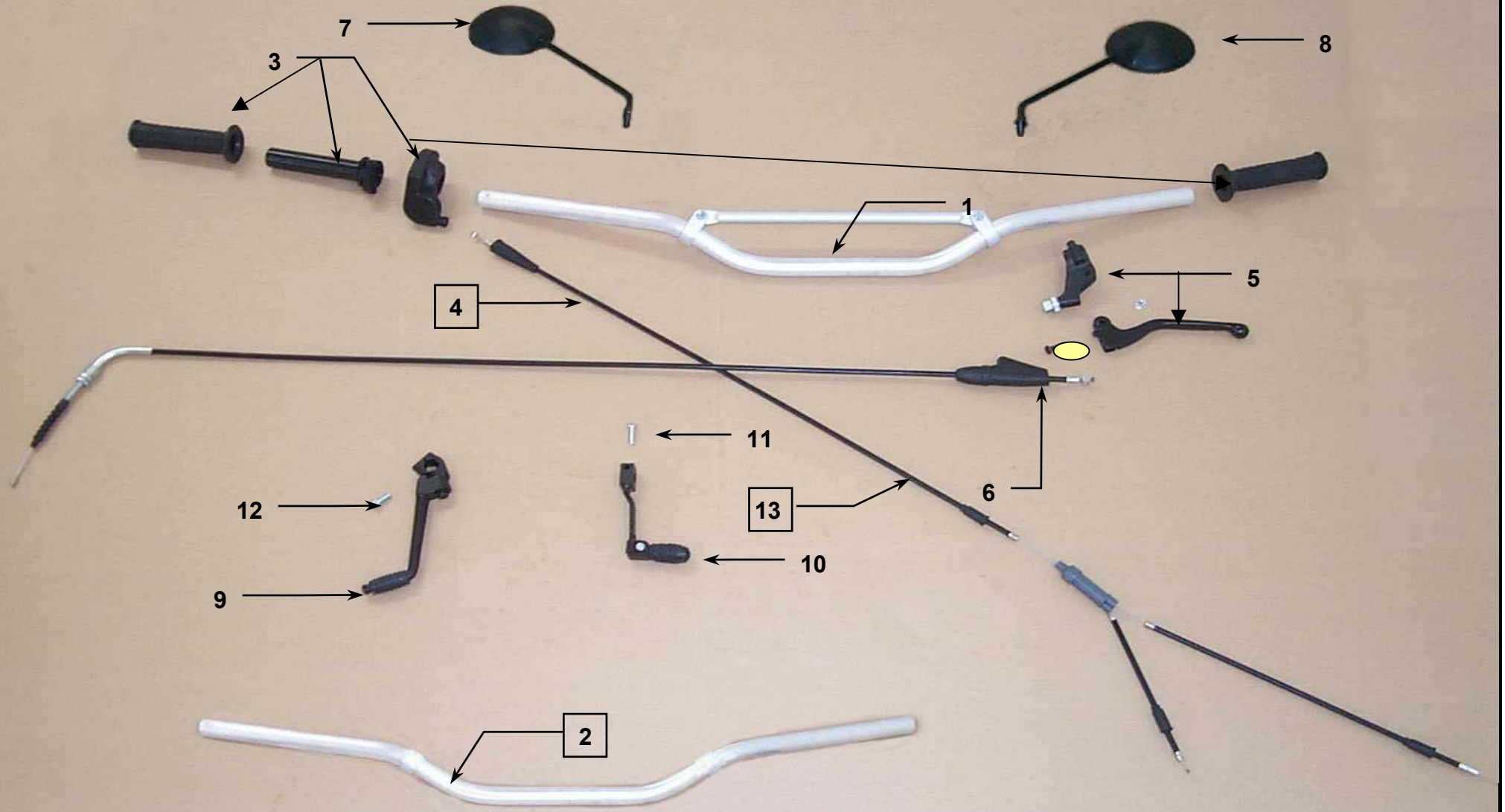

Rep
1
2
3
4
5
6
7
8
9
10
11
12
13
14
15
16
17
18
19
20

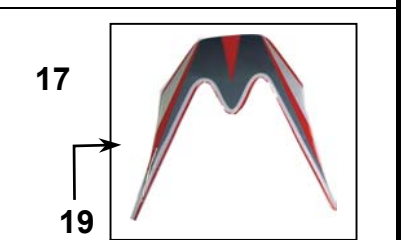
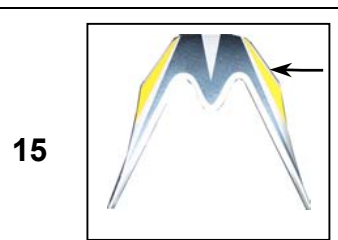
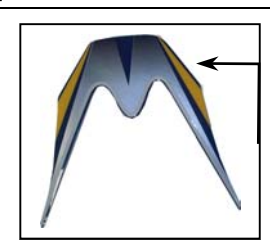
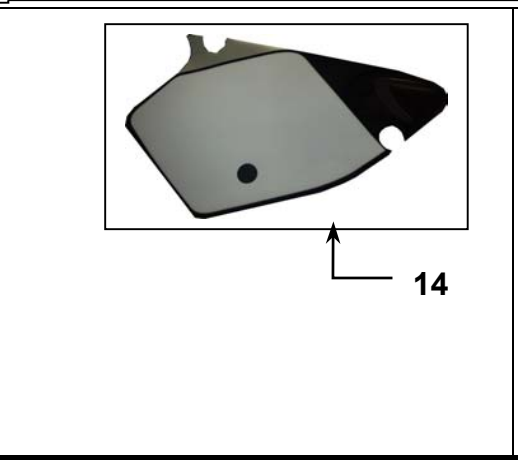
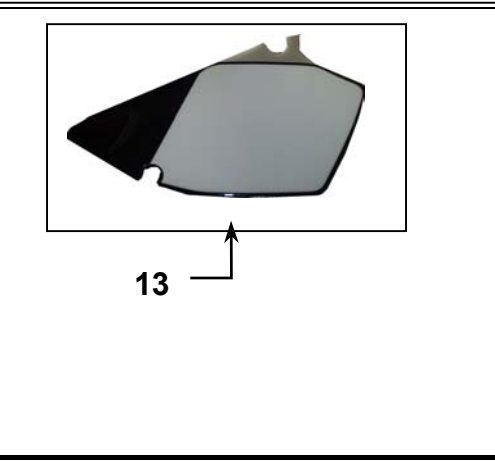
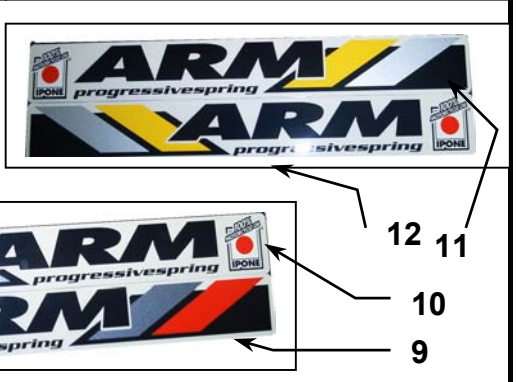
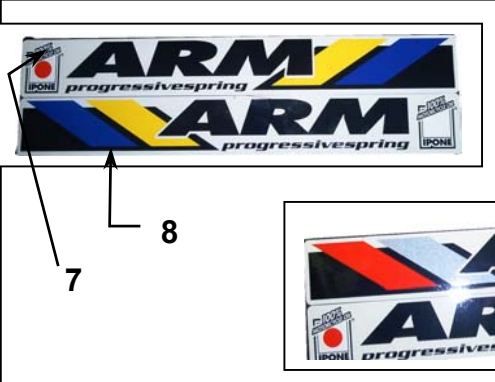
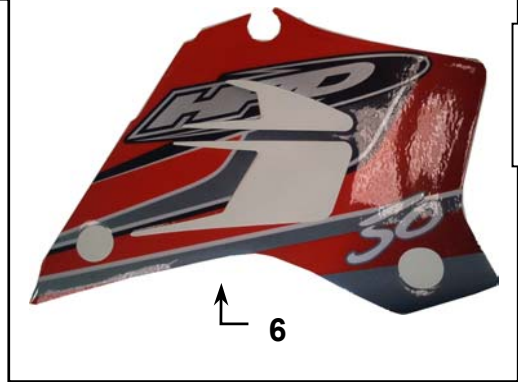
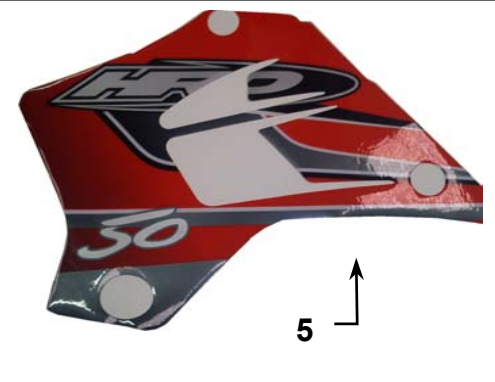
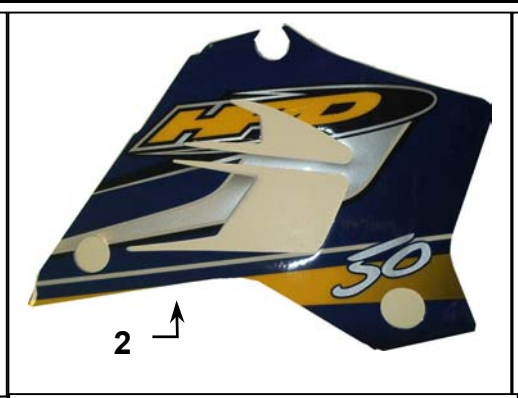

Rep

- 1
- 2
- 3
- 4
- 5
- 6
- 7
- 8
- 9
- 10
- 11
- 12
- 13
- 14
- 15

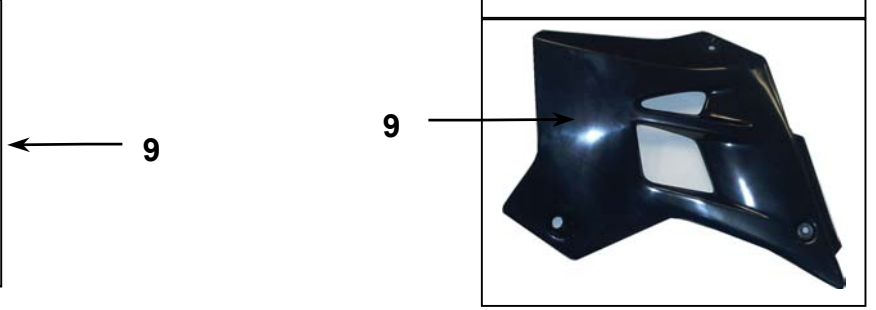
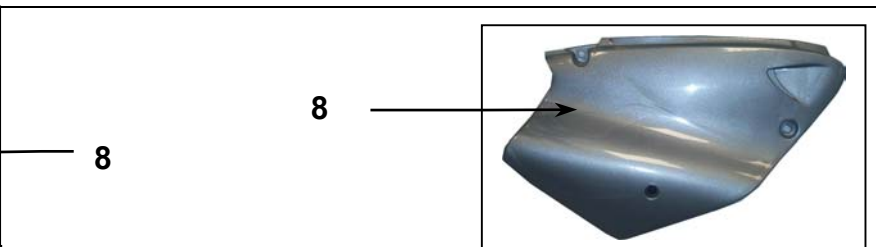
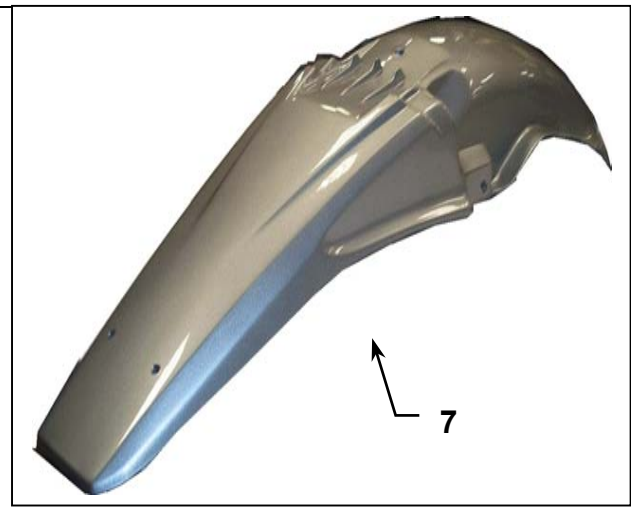
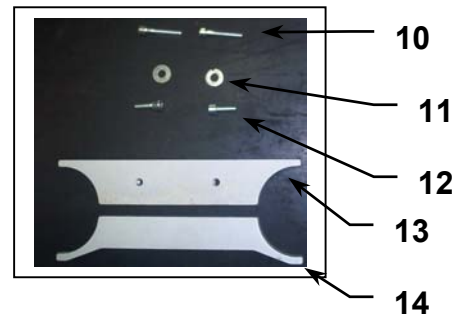
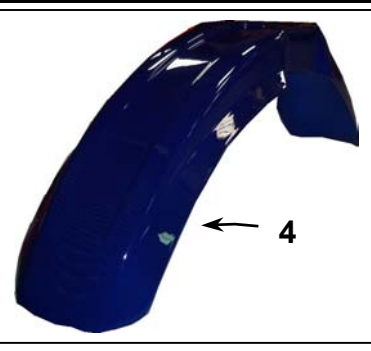
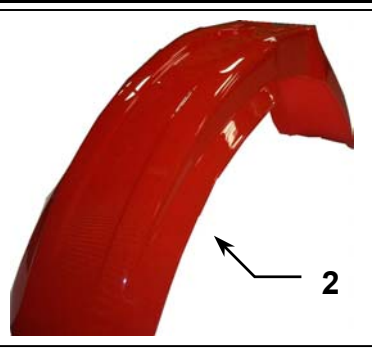
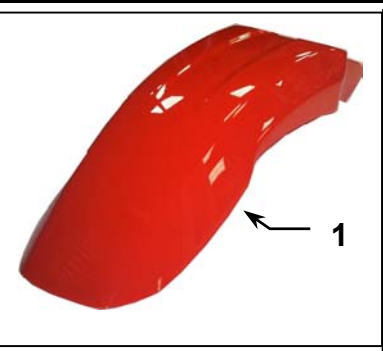

Rep

1

2

3



SHERCO 50

SCHEMA ELECTRIQUE

ENDURO
SUPERMOTARD

22

SCHEMA ELECTRIQUE SHERCO 2002

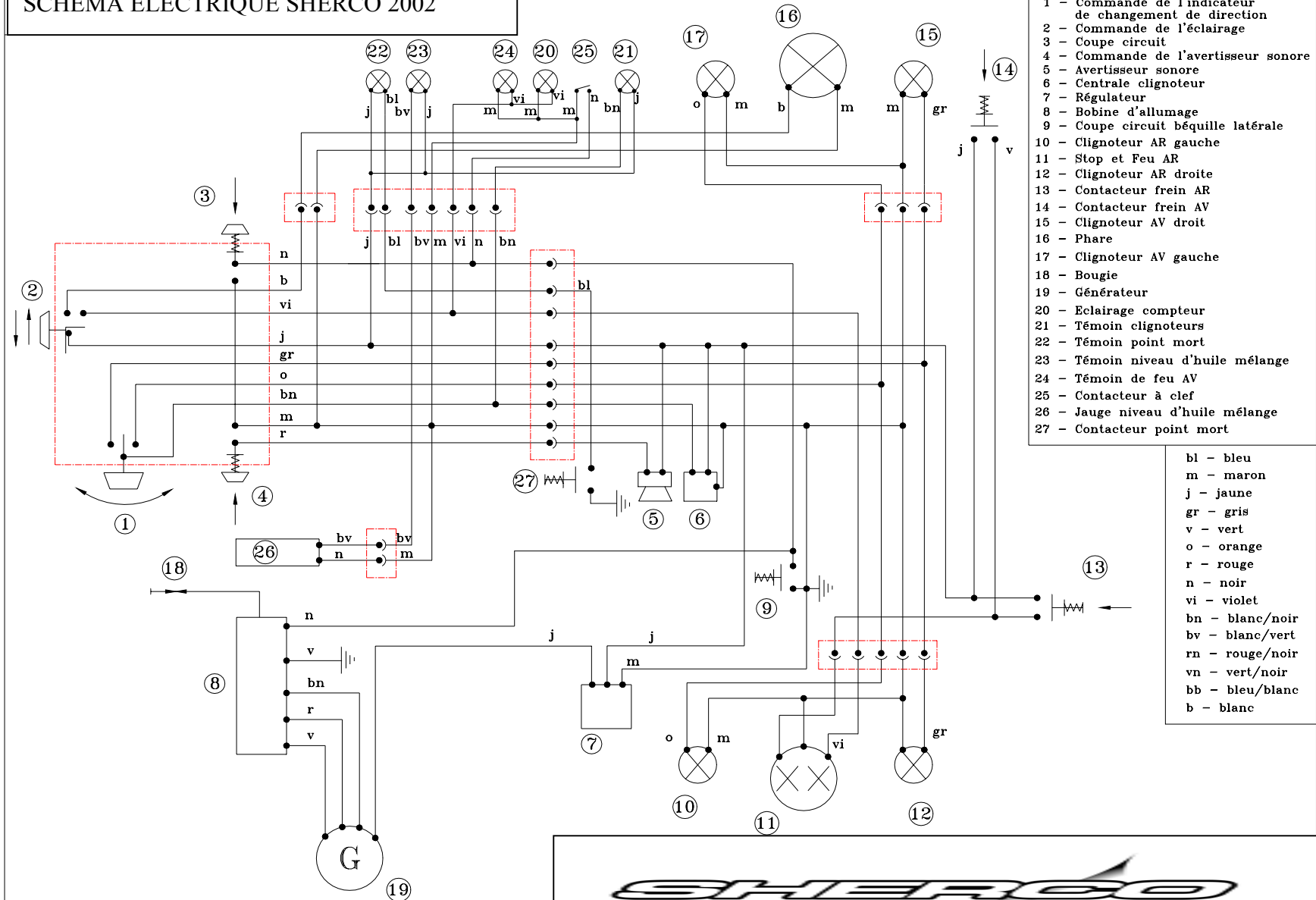

SHERCO 50

ENDURO
SUPERMOTARD

MOTEUR NON CATALYSE

23

AM6

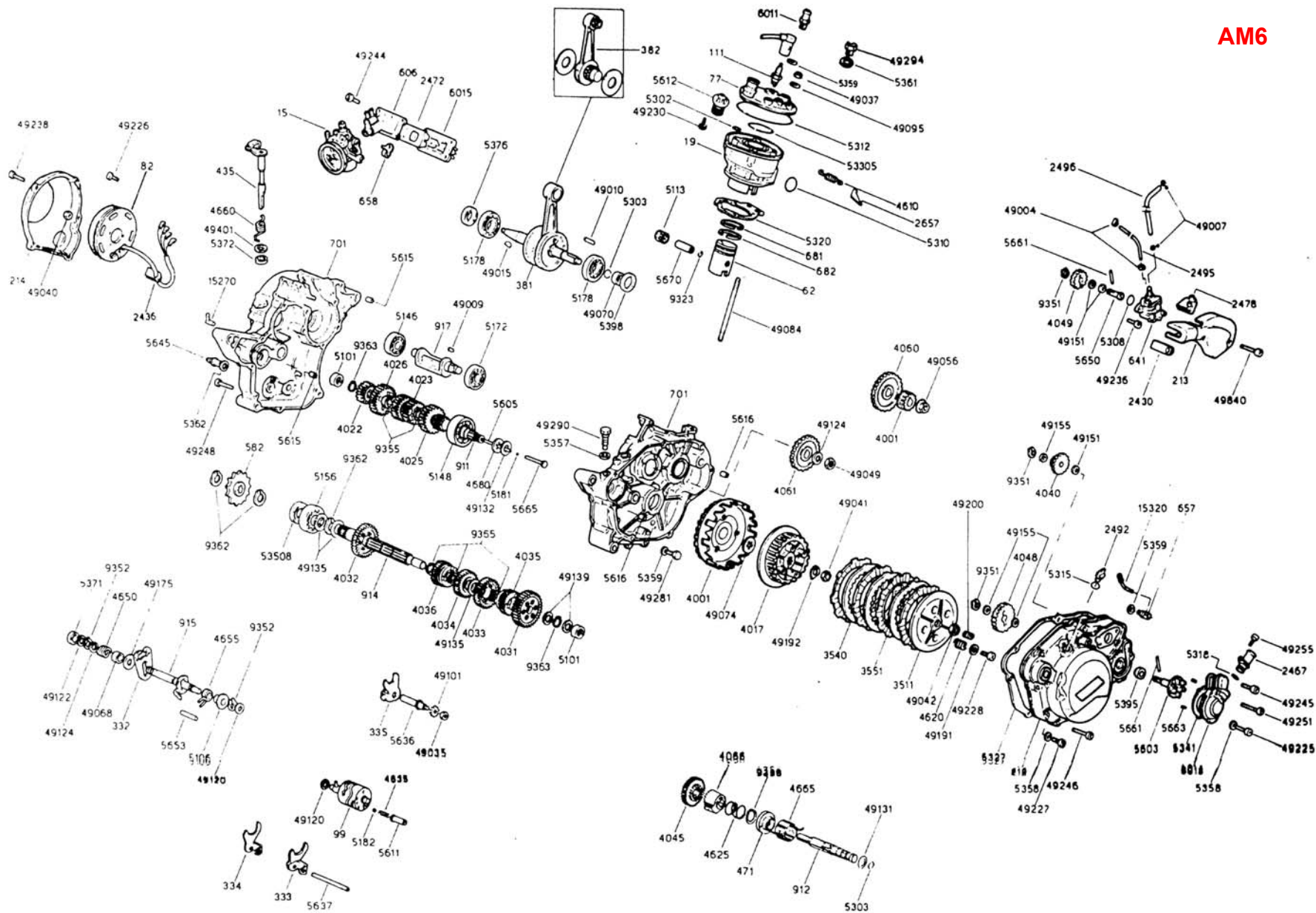

POS	QTS	50 SM	50 END	FRANCAIS	ANGLAIS	ESPAGNOL
1	1	H171	H171	CADRE	FRAME	CHASSIS
2	1	H190	H190	PORTE PAQUET	CARRY PACKAGE	PORTA EQUIPAJES
3	1	H184	H184	RENFORT GARDE BOUE ARRIERE	REINFORCEMENT REAR MUDGUARD	REFUERZO GB TRASERO
4	1	H181	H181	SUPPORT CALE PIED AR D	RIGHT FOOTREST SUPPORT	SOPORTE ESTRIBO TRAS DERECHA
5	1	H182	H182	SUPPORT CALE PIED AR G	LEFT FOOTREST SUPPORT	SUPORTE ESTRIBO TRAS IZQUIERDA
6	1	H179	H179	BEQUILLE	LATERAL STAND	CABALLETE
7	1	H175	H175	CALE PIED AV D	FRONT RIGHT FOOTREST	DELANTERO ESTRIBERA DERECHA
8	1	H174	H174	CALE PIED AV G	FRONT LEFT FOOTREST	DELANTERO ESTRIBERA IZQUIERDA
9	1	H183	H183	CALE PIED AR D	REAR RIGHT FOOTREST	TRASERO ESTRIBERA DERECHA
10	1	H186	H186	CALE PIED AR G	REAR LEFT FOOTREST	TRASERO ESTRIBERA IZQUIERDA
11	1	H066	H066	ROULETTE INFERIEURE GROSSE	BOTTOM BIG CASTOR	RODILLO INFERIOR GRANDE
12	1	H069	H069	ROULETTE SUPERIEURE PETITE	TOP SMALL CASTOR	RODILLO SUPERIOR PEQUENO
13	1	H173	H173	ANTIVOL	ANTI-THEFT LOCK	ANTIRROBO
14	1	H201	H201	RESSORT CALE PIED D	RIGHT FOOTREST SPRING	MUELLE ESTRIBERA DERECHA
15	1	H202	H202	RESSORT CALE PIED G	LEFT FOOTREST SPRING	MUELLE ESTRIBERA IZQUIERDA
16	1	H203	H203	RESSOT BEQUILLE	SIDE STAND SPRING	MUELLE CABALLETE
17	1	H112	H112	ENTRETOISE BEQUILLE	SPACER STAND	CASQUILLO CABALLETE
18	1	H111	H111	VIS DE BEQUILLE	STAND SCREW	TORNILLO CABALLETE
19	3	C412	C412	VIS CHC M8*100	SCREW CHC M8*100	TORNILLO M8*100
20	2	M256	M256	VIS CHC M6*45	SCREW CHC M6*45	TORNILLO M6*45
21	1	M251	M251	VIS CHC M6*16	SCREW CHC M6*16	TORNILLO M6*16
22	2	C422	C422	VIS HEXA M8*45	SCREW M8*45	TORNILLO M8*45
23	2	C421	C421	VIS HEXA M8*40	SCREW M8*40	TORNILLO M8*40
24	2	M252	M252	VIS BHC M6*20	SCREW BHC M6*20	TORNILLO BHC M6*20
25	4	M283	M283	VIS BHC M6*16	SCREW BHC M6*16	TORNILLO BHC M6*16
26	1	M306	M306	ECROU NYLSTOP	NUT NYLSTOP M6	TUERCA NYLSTOP
27	1	M306	M306	ECROU NYLSTOP	NUT NYLSTOP M6	TUERCA NYLSTOP
28	6	M305	M305	ECROU NYLSTOP M8	NUT NYLSTOP M8	TUERCA NYLSTOP M8
29	1	C427	C427	RONDELLE M6*15	WASHER M6*15	ARENDELA M6*15
30	9	C430	C430	RONDELLE M8	WASHER M8	ARENDELA M8
31	2	C440	C440	ECROU BORGNE 6	NUT BORGNE M6	TUERCA BORGNE M6
32	1	C410	C410	VIS CHC M6*25	SCREW CHC M6*25	TORNILLO CHC M6*25

POS	QTS	50 SM	50 END	FRANCAIS	ANGLAIS	ESPAGNOL
1	2	R340	R340	BRIDE GUIDON SUPERIEURE	TOP BAR U-CLAMP	BRIDA SUPERIOR MANILLAR
2	1	R341	R341	T SUPERIEUR	UPPER PLATE	PLATINA SUPERIOR
3	1	R342	R342	T INFERIEUR	BOTTOM PLATE	PLATINA INFERIOR CON EJE
4	1	R343	R343	BRAS DROIT COMPLET	FORK LEG RIGHT	BOTELLA DERECHA
5	1	R344	R344	BRAS GAUCHE COMPLET	FORK LEG LEFT	BOTELLA IZQUIERDA
6	2	H006	H006	KIT ROULEMENT	KIT STEERING BEARING	COJINETE DIRECCION KIT
7	1	R345	R345	ECROU M25	NUT NYLSTOP M25	TUERCA NYLSTOP M25
8	1	R346	R346	BOUCHON DE COLONNE	PLUG	TAPON
9	1	R347	R347	ECROU M25 A ERGOTS	STEERING NUT	TUERCA DIRECCION
10	2	H067	H067	FIXATION CABLE ET DURITE	TUBE AND CABLE FIXATION	FIJACION CABLE Y TUBO
11	2	H008	H008	JOINT TORIQUE	O-RING	TORICA
12	2	H176	H176	RONDELLE COLONNE	WASHER STEERING	ARENDELA APOYO
13	2	R348	R348	PARE POUSSIERE	O-RING	GUARDA POLVO MORQUILLA
14	1	H013	H013	FOURCHE COMPLETE	FRONT FORK COMPLETE	SUSPENSION DELANTERA CPLT
15	4	PAIOL	PAIOL	VIS CHC M8*35	SCREW CHC M8*35	TORNILLO CHC M8*35
16	2	M250	M250	VIS CHC M5*16	SCREW CHC M5*16	TORNILLO CHC M5*16
17	2	M355	M355	ECROU NYLSTOP M5	NUT NYLSTOP M5	TUERCA NYLSTOP M5
18	2	R349	R349	JT SPI	RING FORK	TORICA SUPENSION

POS	QTS	50 SM	50 END	FRANCAIS	ANGLAIS	ESPAGNOL
1	1	H011	H011	AMORTISSEUR	REAR SHOCK	AMORTIGUADOR
2	1	M259	M259	VIS CHC M10*50	SCREW CHC M10*50	TORNILLO CHC M10*50
3	1	C407	C407	VIS CHC M10*45	SCREW CHC M10*45	TORNILLO CHC M10*50
4	1	M304	M304	ECROU NYLSTOP M10	NUT NYLSTOP M10	TUERCA NYLSTOP M10
5	2	C424	C424	RONDELLE M10	WASHER M10	ARENDELA M10

POS	QTS	50 SM	50 END	FRANCAIS	ANGLAIS	ESPAGNOL
1	1	H169	H169	BRAS OSCILLANT	SWINGARM	BASCULANTE
2	1	H068	H068	GUIDE CHAINE	CHAIN GUIDE	GUID CADENA
3	1	H065	H065	PATIN BRAS	CHAIN GUIDE PLATE	PATIN CADENA
4	1	H185	H185	ESCARGOT TENDEUR DROIT	RIGHT SNAIL CAM ADJUSTER	EXCENTRICA DERECHA
5	1	H180	H180	ESCARGOT TENDEUR GAUCHE	LEFT SNAIL CAM ADJUSTER	EXCENTRICA IZQUIERDA
6	2	H007	H007	ROULEMENT AIGUILLE	BEARING	COJINETTE BASCULANTE
7	2	H009	H009	JT SPI	SWINGARM SEAL	RETEN CIGUENAL
8	1	H125	H125	ENTRETOISE BRAS LONGUE	LONG SPACER SUSPENSION	CASQUILLO EJE BASCULANTE LARGA
9	2	H120	H120	ENTRETOISE BRAS COURTE	SMALL SPACER SUSPENSION	CASQUILLO EJE BASCULANTE CORTA
10	1	H127	H127	AXE BRAS OSCILLANT	SWINGARM AXLE	EJE BASCULANTE
11	1	C416	C416	ECROU NYLSTOP M14	NUT NYLSTOP M14	TUERCA NYLSTOP M14
12	1	C425	C425	RONDELLE M14	WASHER M14	ARENDELA M14
13	2	C432	C432	VIS FHC M6*16	SCREW FHC M6*16	TORNILLO FHC M6*16
14	2	C433	C433	VIS FHC M8*10	SCREW M8*10	TORNILLO FHC M8*10
15	2	H273	H273	CLIP FREIN	CLIP BRAKE PIPE	CLIP TUBO FRENO

POS	QTS	50 SM	50 END	FRANCAIS	ANGLAIS	ESPAGNOL
1	1	R350	R350	ETRIER FREIN AVANT	FRONT CALIPER ASSY	PINZA FRENO DELANTERO
2	1	R351	R351	PLAQUETTE FREIN	PAD BRAKE	JUEGO PASTILLAS FRENO
3	1	R352	R352	FLEXIBLE DE FREIN	BRAKE HOSE	LATIGUILLO FRENO DELANTERO
4	1	R353	R353	MAITRE CYLINDRE	FRONT PUMP ASSY	BOMBA FRENO DELANTERO
5	1	R338	R338	LEVIER FREIN	FRONT BRAKE LEVER	MANETA FRENO
6	1	R354	R354	CONTACTEUR FREIN AV	FRONT BRAKE ELECT CONTACT	INTERUPTOR FRENO DELANTERO
7	2	R059	R059	VIS DE RACCORD	BANJO SCREW	TORNILLO RACCORD ULS
8	4	R074	R074	JOINT	BANJO SEAL	ARENDELLA BANJO
9				VIS	SCREW	TORNILLO
10	1	M306	M306	ECROU NYSTOP M6	NUT NYLSTOP M6	TUERCA NYLSTOP M6
11	1	C414	C414	VIS CHC M8*35	SCREW CHC M8*35	TORNILLO CHC M8*35
12	1	C406	C406	VIS CHC M8*50	SCREW CHC M8*50	TORNILLO CHC M8*35
13	2	C430	C430	RONDELLE M8*16	WASHER M8*16	ARENDELLA M8*16
14	1	H207	H207	ETRIER FREIN AVANT COMPLET	KIT FRONT CALIPER ASSY	PINZA FRENO DELANTERO KIT

POS	QTS	50 SM	50 END	FRANCAIS	ANGLAIS	ESPAGNOL
1	1	R355	R355	ETRIER FREIN ARRIERE	REAR BRAKE	PINZA FRENO TRASERO
2	1	R051	R051	PLAQUETTE FREIN	PAD BRAKE	JUEGO PASTILLAS FRENO
3	1	R356	R356	FLEXIBLE FREIN	REAR BRAKE HOSE	LATIGUILLO FRENO TRASERO
4	1	R357	R357	MAITRE CYLINDRE	REAR MASTER CYLINDER	BOMBA FRENO TRASERO
5	1	R066	R066	RESERVOIR LIQUIDE FREIN	REAR BRAKE TANK	DEPOSITO LIQUIDO FRENO
6	1	H196	H196	PEDALE FREIN	REAR BRAKE PEDAL	PEDAL FRENO TRASERO
7	1	H122	H122	CHAPPE PEDALE FREIN	REAR BRAKE ROD	HORQUILLA PEDAL DE FRENO
8	1	H123	H123	ENTRETOISE	SPACER BRAKE PEDAL	CASQUILLO PEDAL DE FRENO
9	1	H121	H121	TIGE DE REGLAGE	BRAKE ROD PIN	TIJA PEDAL FRENO TRASERO
10		H298	H298	VIS CONTACTEUR	BRAKE ELECTRIC CONTACT	INTERUPTOR FRENO TRASERO
11	4	R074	R074	JOINT	BANJO SEAL	ARENDELA BANJO
12	2	R059	R059	VIS RACCORD	BANJO SCREW	TORNILLO RACCORD ULS
13	1	R069	R069	DURITE	PIPE	TUBO
14	1	C419	C419	VIS TH M6*20	SCREW TH M6*20	TORNILLO TH M6 *20
15	1	M263	M263	VIS CHC M8*40	SCREW CHC M8*40	TORNILLO CHC M8*40
15	2	M279	M279	VIS BHC M6*20	SCREW BHC M6*20	TORNILLO BHC M6*20
17	1	C409	C409	VIS CHC M6*10	SREW CHC M6*10	TORNILLO CHC M6*10
18	1	C413	C413	VIS CHC M8*16	SCREW CHC M8*16	TORNILLO CHC M8*16
19	1	M264	M264	VIS CHC M8*45	SCREW CHC M8*45	TORNILLO CHC M8*45
20	2	M306	M306	ECROU NYLSTOP M6	NUT NYLSTOP M6	TUERCA NYLSTOP M6
21	1	M309	M309	ECROU M6	NUT M6	TUERCA M6
22	1	M305	M305	ECROU NYLSTOP M8	NUT NYLSTOP M8	TUERCA NYLSTOP M8
23	2	M317	M317	RONDELLE M6*12	WASHER M6*12	ARENDELA M6*12
24	3	C430	C430	RONDELLE M8	WASHER M8	ARENDELA M8
	1	H206	H206	KIT ETRIER FREIN AR	KIT REAR BRAKE ASSY	GRUPO FRENO TRASERO

POS	QTS	50 SM	50 END	FRANCAIS	ANGLAIS	ESPAGNOL
1	1	H198	H198	POT ECHAPPEMENT	EXHAUST PIPE	ESCAPE
2	1	H200	H200	SILENCIEUX ECHAPPEMENT	SILENCER	SILENCIADOR
3	1	H055	H055	MANCHON POT/SILENCIEUX	CONNECTOR EXHAUST/SILENCER	EMPALME TUBO SILENCIADOR
4	2	H058	H058	SILENT BLOC	SILENT BLOC	SILENT BLOC
5	2	H204	H204	RESSORT DE POT	EXHAUST SPRING	MUELLE ESCAPE
6	2	C409	C409	VIS CHC M6*10	SCREW CHC M6*10	TORNILLO CHC M6*10
7	1	M251	M251	VIS CHC M6*16	SCREW CHC M6*16	TORNILLO CHC M6*16
8	1	C410	C410	VIS CHC M6*25	SCREW CHC M6*25	TORNILLO M6*25
9	3	M306	M306	ECROU NYLSTOP M6	NUT NYLSTOP M6	TUERCA NYLSTOP M6
10	4	M317	M317	RONDELLE M6*12	WASHER M6*12	ARENDELA M6*12
11	2	C427	C427	RONDELLE M6*15	WASHER M6*15	ARENDELA M6*15
	MODELE CATALYSE					
12	1	H199	H199	POT ECHAPPEMENT	EXHAUST PIPE	ESCAPE
13	1	H056	H056	MANCHON POT/SILENCIEUX	CONNECTOR EXHAUST/SILENCER	EMPALME TUBO SILENCIADOR
14	1	H005	H005	RONDELLE ISOLANTE	INSULATION WASHER	ARANDELA AISLAMIENTO

POS	QTS	50 SM	50 END	FRANCAIS	ANGLAIS	ESPAGNOL
1	1	H035	H035	RESERVOIR ESSENCE	FUEL TANK	DEPOSITO GASOLINA
2	1	H031	H031	BOUCHON RESERVOIR	PETROL CAP	TAPON GASOLINA
3	1	H211	H211	ROBINET ESSENCE	PETROL TAP	GRIFO GASOLINA
4	1	H041	H041	DURITE ESSENCE	PETROL PIPE	TUBO GASOLINA
5	1	H040	H040	DURITE RENIFLARD	PIPE DEPRESSION	TUBO DEPRESOR
6	1	H118	H118	FIXATION SELLE	FASTENING SEAT	FIJATION ASIENTO
7	2	M278	M278	VIS BHC M5*10	SCREW BHC M5*10	TORNILLO BHC M5*10
8	1	M279	M279	VIS BHC M6*20	SCREW BHC M6*20	TORNILLO BHC M6*20
9	1	C406	C406	VIS CHC M8*50	SCREW CHC M8*50	TORNILLO CHC M8*50
10	1	C430	C430	RONDELLE M8	WASHER M8	ARENDELA M8

POS	QTS	50 SM	50 END	FRANCAIS	ANGLAIS	ESPAGNOL
1	1	H037	H037	RESERVOIR HUILE	OIL TANK	DEPOSITO ACEITE
2	1	H036	H036	BOUCHON RESERVOIR HUILE	OIL CAP	TAPON ACEITE
3	1	H159	H159	SONDE NIVEAU HUILE	OIL LEVEL SOND	SONDA NIVEL ACEITE
4	1	H205	H205	RESSORT DURITE HUILE	SPRING OIL PIPE	MUELLE TUBO ACEITE
5	1	H220	H220	RADIATEUR	RADIATOR	RADIATOR
6	1	R046	R046	BOUCHON RADIATEUR	RADIATOR CAP	TAPON RADIATOR
7	1	H028	H028	GRILLE RADIATEUR	RADIATOR COVER	REJILLA RADIATOR
8	1	H049	H049	DURITE SUPERIEURE	TOP PIPE	TUBO SUPERIOR
9	1	H047	H047	DURITE INFERIEURE	BOTTOM PIPE	TUBO INFERIOR
10	1	H048	H048	DURITE RECHAUFFEUR	RISE PIPE	TUBO CALENTADOR
11	1	H046	H046	DURITE TROP PLEIN	TOP FULL PIPE	TUBO REBOSADERO
12	3	H059	H059	SILENT BLOC RADIATEUR	RADIATOR ABSORBER	SILENT BLOC RADIADOR
13	1	H262	H262	COLLIER CLIC 86-245	COLLAR CLIC	ABRAZADERA CLIC
14	3	H261	H261	COLLIER CLIC 86-230	COLLAR CLIC	ABRAZADERA CLIC
15	1	H264	H264	COLLIER CLIC 55/80	COLLAR CLIC	ABRAZADERA CLIC
16	4	H263	H263	COLLIER CLIC 66-125	COLLAR CLIC	ABRAZADERA CLIC
17	1	M308	M308	AGRAFE M6	NUT CLIP M6	TUERCA CLIP M6
18	2	M378	M378	ECROU CLIP M5	NUT CLIP M5	TUERCA CLIP M5
19	2	M278	M278	VIS BHC 5*10	SCREW BHC 5*10	TUERCA CHC 5*10
20	5	C409	C409	VIS CHC 6*10	SCREW CHC 6*10	TUERCA CHC 6*10
21	3	C428	C428	RONDELLE M6*20	WASHER M6*20	ARENDELA M6*20

POS	QTS	50 SM	50 END	FRANCAIS	ANGLAIS	ESPAGNOL
1	1	H033	H033	BOITE FILTRE	FILTER BOX	CAJA FILTRO
2	1	H064	H064	MOUSSE FILTRE AIR	FILTER	ESPUMA FILTRO
3	1	H076	H076	COUVERCLE FILTRE AIR	FILTER BOX COVER	TAPA FILTRO
4	1	H044	H044	MANCHON CARBURATEUR	CARBURETTOR CONNECTOR	TOBERA CARBURADOR
5	2	C415	C415	COLLIER ZEBRA	JULIBEE ZEBRA	ABRAZEDRA ZEBRA
6	1	M251	M251	VIS CHC M6*16	SCREW CHC M6*16	TORNILLO CHC M6*16
7	1	M284	M284	VIS BHC M6*25	SCREW BHC M6*20	TORNILLO BHC M6*20
8	1	M252	M252	VIS CHC M6*20	SCREW CHC M6*20	TORNILLO CHC M6*20
9	2	C427	C427	RONDELLE M6*15	WASHER M6*15	ARENDELA M6*15
		MODELE CATALYSE				
10	1	H057	H057	REDUCTEUR CARBURATEUR	CARBURETTOR REDUCTOR	REDUCTOR CARBURADOR

POS	QTS	50 SM	50 END	FRANCAIS	ANGLAIS	ESPAGNOL
1	1	H138	H138	FAISCEAU ELECTRIQUE	ELECTRIC CABLE	INSTALACION ELECTRICA
2	1	H153	H153	COMMODO ELECTRIQUE	SWITCH	COMMUTADOR
3	1	H133	H133	BOBINE HAUTE TENSION CDI	IGNITION COIL	BOBINA
4	1	H146	H146	ANTIPARASITE	SPARK PLUG CAP	PIPA BUJIA
5	1	H147	H147	CONTACTEUR DE BEQUILLE	SWITCH STAND	CONTACTOR CABALLETE
6	1	H158	H158	CENTRALE CLIGNOTEUR	TURN LIGHT CENTRAL	CENTRAL DE INTERMITENCIA
7	1	H148	H148	REGULATEUR	REGULATOR COIL	REGULADOR
8	1	H165	H165	KLAXON	KLAXON	CLAXON
9	2	C409	C409	CHC M6*10	SCREW CHC M6*10	TORNILLO CHC M6*10
10	2	M251	M251	CIS CHC M6*16	SCREW CHC M6*16	TORNILLO CHC M6*16
11	1	M253	M253	VIS CHC M6*30	SCREW CHC M6*30	TORNILLO CHC M6*30
12	1	M279	M279	VIS BHC M6*20	SCREW BHC M6*20	TORNILLO BHC M6*20
13	1	C427	C427	RONDELLE M6*15	WASHER M6*15	ARENDELA M6*15

POS	QTS	50 SM	50 END	FRANCAIS	ANGLAIS	ESPAGNOL
1	1	H030	H030	PLAQUE PHARE	SUPPORT HEADLIGHT	PLACA FARO
2	1	H163	H163	PHARE NON VISSE	HEADLIGHT	FARO
3	1	H248	H248	AMPOULE PHARE AV	BULB LIGHT	BOMBINA FARO
4	4	H050	H050	FIXATION CAOUTCHOUC	FIXATION SUPPORT HEADLIGHT	GOMA FIJACION
5	2	H166	H166	CLIGNOTANT AV D/AR G	DIRECTIONAL SIGNAL F/R REAR/L	INTERMITENTE DEL/D Y TRAS/I
6	2	H167	H167	CLIGNOTANT AV G/AR D	DIRECTIONAL SIGNAL F/L REAR/R	INTERMITENTE DEL/I Y TRAS/D
7	1	H026	H026	BAVETTE PORTE PLAQUE	REAR NUMBER PLATE HOLDER	SOPORTE MATRICULA
8	1	H160	H160	CAPUCHON FEU AR	REAR LIGHT COVER	CAPUCHON PILOTO TRASERO
9	1	H042	H042	JOINT FEU AR	REAR LIGHT GASKET	JUNT PILOTO TRASERO
10	1	H252	H252	AMPOULE FEU ARRIERE	REAR LIGHT BULB	BOMBILLA PILOTO TRASERO
11	4	M283	M283	VIS BHC M6*16	SCREW BHC M6*16	TORNILLO BHC M6*16
12	2	C431	C431	VIS TCB M5*50	SCREW TCB M5*50	TORNILLO TCB M5*50
13	6	M306	M306	ECROU AUTOBLOQUANT M6	NUT NYLSTOP M6	TUERCA NYLSTOP M6
14	2	M355	M355	ECROU AUTOBLOQUANT M5	NUT NYSLTOP M5	TUERCA NYLSTOP M5
15	8	M317	M317	RONDELLE M6*12	WASHER M6*12	ARANDELA M6*12
16	2	M379	M379	RONDELLE M5*15	WASHER M5*15	ARANDELA M5*15
17	1	H268	H268	FAISCEAU PORTE AMPOULE AR	REAR LIGHT CABLE	INSTALACION BOMBILA TRASERA
18	1	H025	H025	BAVETTE	REAR SHOCK COVER	PROTECTOR AMORTIGUADOR
19	2	M251	M251	VIS CHC M6*16	SCREW CHC M6*16	TORNILLO CHC M6*16

POS	QTS	50 SM	50 END	FRANCAIS	ANGLAIS	ESPAGNOL
1	1	H156	H156	TABLEAU DE BORD	SPEEDMETER TABLE	TABLIER
2	1	H155	H155	CONTACTEUR A CLEF	KEY CONTACT	LLAVE CONTACTO
3	1	H135	H135	CABLE COMPTEUR	SPEEDMETER CABLE	CABLE CUENTA KM
4	1	R364	R364	AMPOULE TEMOIN	BULB	BOMBILLA
5	1	H191	H191	PATTE TABLEAU DE BORD	SPEEDMETER TABLE SUPPORT	PATA TABLIER
6	2	C440	C440	ECROU BORGNE M6	NUT M6	TUERCA M6
7	2	C410	C410	VIS CHC M6*25	SCREW CHC M6*25	TORNILLO CHC M6*25

POS	QTS	50 SM	50 END	FRANCAIS	ANGLAIS	ESPAGNOL
1	1		H084	PNEUMATIQUE AV	FRONT TYRE TRAIL	NEUMATICO DELANTERO
2	1		H077	CHAMBRE AIR	FONT INNER TUBE 300*21	CAMARA DELANTERO 300*21
3	1		H078	FOND DE JANTE	FRONT RIM RUBBER BAND	PROTECTOR LLANTA
4	1		H093	JANTE	FRONT RIM TRAIL	LLANTA
5	36		H097	RAYON	FRONT SPOKE	RADIO
6	36		H089	ECROU DE RAYON	SPOKE HEAD	TUERCA RADIO
7	1		H091	MOYEU COMPLET	FRONT HUB	BUJE COMPLETO DELANTERO
8	2		R360	ROULEMENT MOYEU AV	BEARING FRONT HUB	CASQUILLO BUJE DELANTERO
9	1		R359	ENTRETOISE INTERIEURE	FRONT HUB SPACER	SEPARADOR BUJE DELANTERO
10	1		H114	ENTRETOISE ROUE	FRONT WEEL BRACE	SEPARADOR
11	1		H113	AXE DE ROUE	FRONT WEEL AXLE	CASQUILLO RUEDA
12	1		H136	PRISE COMPTEUR TRAIL	SPEED METER INTAKE	REENVIO CUENTA KM
13	1		H099	DISQUE DE FREIN	FRONT BRAKE DISC	DISCO FRENO DELANTERO
14	6		M249	VIS CHC M6*20 BASSE	SCREW CHC M6*20	TORNILLO CHC M6*20

POS	QTS	50 SM	50 END	FRANCAIS	ANGLAIS	ESPAGNOL
1	1		H086	PNEUMATIQUE ARRIERE	REAR TYRE	NEUMATICO TRASERO
2	1		H088	CHAMBRE A AIR	REAR INNER TUBE	CAMARA TRASERO
3	1		H079	FOND DE JANTE	REAR RIM RUBBER BAND	PROTECTOR LLANTA
4	1		H095	JANTE	REAR RIM TRAIL	LLANTA TRASERA
5	36		H098	RAYON	REAR SPOKE	RADIO
6	36		H089	ECROU DE RAYON	SPOKE HEAD	TUERCA RADIO
7	1		H090	MOYEU COMPLET	REAR HUB	BUJE COMPLETO TRASERO
8	2		R362	ROULEMENT MOYEU AR	BEARING REAR HUB	CASQUILLO BUJE TRASERO
9	1		R363	ENTRTOISE MOYEU INTERNE	REAR HUB SPACER	SEPARADOR BUJE TRASERO
10	1		H115	ENTRTOISE ROUE AR	REAR WEEL BRACE	SEPARADOR
11	1		H119	AXE DE ROUE	REAR WEEL AXLE	CASQUILLO RUEDA
12	1		H100	DISQUE 3 TROUS	REAR BRAKE DISC 3 DRILL	DISCO FRENO TRASERO
13	3		H104	VIS DISQUE	BRAKE DISC SCREW	TORNILLO DE DISCO DE FRENO
14	1		H177	SUPPORT ETRIER DE FREIN	REAR BRAKE CALIPPER SUPPORT	SOPORTE PINZA
15	1		H106	CHAINE	CHAIN 134 Z	CADENA
16	1		H108	COURONNE 56 DENTS	REAR SPROCKET 56 Z	CORONA 56 DIENTES
17	1		C417	ECROU NYLSTOP M16*150	NUT NYLSTOP M16*150	TUERCA NYLSTOP M16*150
18	6		C421	VIS TH 8*40	SCREW TH M8*40	TORNILLO TH M8*40
19	1		C426	RONDELLE M16	WASHER M16	ARENDELA M16

POS	QTS	50 SM	50 END	FRANCAIS	ANGLAIS	ESPAGNOL
1	1	H080		PNEUMATIQUE AV	FRONT TYRE SM	NEUMATICO DELANTERO
2	1	H081		CHAMBRE A AIR	FRONT INNER TUBE	CAMARA DELANTERO
3	1	H079		FOND DE JANTE	FRONT RIM RUBBER BAND	PROTECTOR LLANTA
4	1	H092		JANTE	FRONT RIM SM	LLANTA DELANTERA
5	36	H096		RAYON	FRONT SPOKE	RADIO
6	36	H089		ECROU DE RAYON	SPOKE HEAD	TUERCA RADIO
7	1	H091		MOYEU COMPLET	FRONT HUB	BUJE COMPLETO
8	2	R360		ROULEMENT	BEARING FRONT HUB	CASQUILLO BUJE DELANTERO
9	1	R359		ENTRETOISE INTERNE	SPACER FRONT HUB	SEPARADON BUJE DELANTERO
10	1	H114		ENTRETOISE DE ROUE	FRONT WEEL BRACE	SEPARADOR
11	1	H113		AXE DE ROUE	FRONT WEEL AXLE	CASQUILLO RUEDA
12	1	H134		PRISE COMPTEUR SUPER MOT	SPEED METER INTAKE	REENVIO CUENTA KM
13	1	H099		DISQUE DE FREIN AV	FRONT BRAKE DISC	DISCO FRENO
14	6	H104		VIS DISQUE	DISC SCREW	TORNILLO DE DISCO

POS	QTS	50 SM	50 END	FRANCAIS	ANGLAIS	ESPAGNOL
1	1	H083		PNEUMATIQUE ARRIERE	REAR TYRE SM	NEUMATICO DELANTERO
2	1	H082		CHAMBRE AIR	REAR INNER TUBE	CAMARA
3	1	H079		FOND DE JANTE	REAR RIM RUBBER BAND	PROTECTOR LLANTA
4	1	H094		JANTE	REAR RIM SM	LLANTA
5	36	H096		RAYON	REAR SPOKE	RADIO
6	36	H089		ECROU DE RAYON	REAR SPOKE HEAD	TUERCA RADIO
7	1	H090		MOYEU	REAR HUB	BUJE COMPLETO
8	2	R362		ROULEMENT	BEARING REAR HUB	CASQUILLE BUJE TRASERO
9	1	R363		ENTRETOISE INTERNE	SPACER REAR HUB	SEPARADOR BUJE TRASERO
10	1	H115		ENTRETOISE DE ROUE	REAR WEEL BRACE	SEPARADOR
11	1	H119		AXE DE ROUE M16	REAR WEEL AXLE	CASQUILLO RUEDA
12	1	H100		DISQUE FREIN 3 TROUS	REAR BRAKE DISC 3 DRILL	DISCO FRENO TRASERO
13	3	H104		VIS DISQUE	BRAKE DISC SCREW	TORNILLO DE DISCO DE FRENO
14	1	H177		SUPPORT ETRIER DE FREIN	REAR BRAKE CALIPPER SUPPORT	SOPORTE PINZA
15	1	H106		CHAINE	CHAIN 134 Z	CADENA
16	1	H108		COURONNE 56 DTS	REAR SPROCKET 56 Z	CORONA 56 DIENTES
17	1	C417		ECROU NYLSTOP M16*150	NUT NYLSTOP M16*150	TUERCA NYLSTOP M16*150
18	6	C421		VIS HEXA M8*40	SCREW TH M8*40	TORNILLO TH M8*40
19	1	C426		RONDELLE M16	WASHER M16	ARENDELA M16

POS	QTS	50 SM	50 END	FRANCAIS	ANGLAIS	ESPAGNOL
1	1		H208	GUIDON TRAIL	TRAIL HANDLEBAR	MANILLAR TRAIL
2	1	H210		GUIDON SUPER MOTARD	SM HANDLEBAR	MANILLAR SM
3	1	H213	H213	POIGNEE DE GAZ	THROTTLE COMMAND	PUNO GAS
4	1	H142	H142	CABLE DE GAZ	THROTTLE CABLE	CABLE GAS
5	1	H221	H221	KIT LEVIER EMBRAYAGE	KIT CLUTCH COMMAND	KIT MANDO EMBRAGUE
6	1	H144	H144	CABLE EMBRAYAGE	CLUTCH CABLE	CABLE EMBRAGUE
7	1	H219	H219	RETROVISEUR DROIT	RIGHT MIRROR	RETROVISOR DERECHO
8	1	H218	H218	RETROVISEUR GAUCHE	LEFT MIRROR	RETROVISOR IZQUIERDO
9	1	H212	H212	KICK ALU	KICK STARTER PEDAL ALUM	PEDAL ARRANQUE
10	1	H209	H209	SELECTEUR ALU	GEAR PEDAL ALUM	SELECTOR
11	1	M252	M252	VIS CHC M6*20	SCREW CHC M6*20	TORNILLO CHC M6*20
12	1	C410	C410	VIS CHC M6*25	SCREW CHCM6*25	TORNILLO CHC M6*25
	MODELE CATALYSE					
13	1	H143	H143	CABLE GAZ	THROTTLE CABLE	CABLE GAS

POS	QTS	50 SM	50 END	FRANCAIS	ANGLAIS	ESPAGNOL
1	1	H242		GB ROUGE AV SUPER MOTARD	FRONT MUDGUARD RED SM	GB ROJO DELANTERO SM
2	1		H235	GB ROUGE AV ENDURO	FRONT MUDGUARD RED ENDURO	GB ROJO DELANTERO ENDURO
3	1	H239		GB BLEU AV SUPER MOTARD	FRONT MUDGUARD BLUE SM	GB AZUL DELANTERO SM
4	1		H236	GB BLEU AV ENDURO	FRONT MUDGUARD BLUE ENDURO	GB AZUL DELANTERO ENDURO
5	1	H024		GB GRIS AV SUPER MOTARD	FRONT MUDGUARD GREY SM	GB GRIS DELANTERO SM
6	1		H023	GV GRIS AV ENDURO	FRONT MUDGUARD GREY ENDURO	GB GRIS DELANTERO ENDURO
7	1	H014	H014	GB ARRIERE TOUS MODELE GRIS	REAR MUDGUARD GREY ALL MODEL	GB GRIS TRASERO TODOS MODELOS
8	1	H015	H015	KIT CACHE LATERAL GRIS	SIDE COVER SET GREY	KIT PLACAS LATERALES GRIS
9	1	H274	H274	KIT OUIE NOIR	KIT RADIATOR COVER BLACK	KIT PLACAS RADIATOR
10	2	C408	C408	VIC CHC M5*30	SCREW CHC M5*30	TORNILLO CHC M5*30
11	1	C427	C427	RONDELLE M6*15	WASHER M6*15	ARENDELA M6*15
12	2	C409	C409	VIS CHC M6*10	SCREW CHC M6*10	TORNILLO CHC M6*10
13	1	H117		PLAQUE SUPPORT GB AR	REAR SUPORT MUDGUARD	PLACA SOPORTO GB TRASERO
14	1	H116		PLAQUE SUPPORT GB AV	FRONT SUPORT MUDGUARD	PLACA SOPORTO GB DELANTERO
15	1	H029		GARDE BOUE	MUDGUARD	GUARDABARO

POS	QTS	50 SM	50 END	FRANCAIS	ANGLAIS	ESPAGNOL
1	1	H281	H281	ADHESIF OUIE GAUCHE BLEU	STICKER RADIA COVER BLUE LEFT	ADHESIVO PLACA RAD AZUL I
2	1	H278	H278	ADHESIF OUIE DROIT BLEU	STICKER RADIA COVER BLUE RIGHT	ADHESIVO PLACA RAD AZUL D
3	1	H283	H283	ADHESIF OUIE GAUCHE GRIS	STICKER RADIA COVER GREY LEFT	ADHESIVO PLACA RAD GRIS I
4	1	H280	H280	ADHESIF OUIE DROIT GRIS	STICKER RADIA COVER GREY RIGHT	ADHESIVO PLACA RAD GRIS
5	1	H282	H282	ADHESIF OUIE GAUCHE ROUGE	STICKER RADIA COVER RED LEFT	ADHESIVO PLACA RAD ROJO I
6	1	H279	H279	ADHESIF OUIE DROIT ROUGE	STICKER RADIA COVER RED RIGHT	ADHESIVO PLACA RAD ROJO D
7	1	H295	H295	ADHESIF BRAS OSCILL D BLEU	STICKER SWINGARM RIGHT BLUE	ADHESIVO BASCULANTE AZUL D
8	1	H292	H292	ADHESIF BRAS OSCILL G BLEU	STICKER SWINGARM LEFT BLUE	ADHESIVO BASCULANTE AZUL I
9	1	H296	H296	ADHESIF BRAS OSCILL D ROUGE	STICKER SWINGARM RIGHT RED	ADHESIVO BASCULANTE ROJO D
10	1	H293	H293	ADHESIF BRAS OSCILL G ROUGE	STICKER SWINGARM LEFT RED	ADHESIVO BASCULANTE ROJO I
11	1	H297	H297	ADHESIF BRAS OSCILL D GRIS	STICKER SWINGARM RIGHT GREY	ADHESIVO BASCULANTE GRIS D
12	1	H294	H294	ADHESIF BRAS OSCILL G GRIS	STICKER SWINGARM LEFT GREY	ADHESIVO BASCULANTE GRIS I
13	1	H285	H285	ADHESIF OUIE PLAQUE LAT G	STICKER SIDE COVER LEFT	ADHESIVO PLACA LATERAL I
14	1	H284	H284	ADHESIF OUIE PLAQUE LAT DROIT	STICKER SIDE COVER RIGHT	ADHESIVO PLACA LATERAL D
15	1	H286	H286	ADHESIF GB AV BLEU	STICKER FRONT MUDGUARD BLUE	ADHESIVO GB DELANTERO AZUL
16	1	H289	H289	ADHESIF PLAQUE PHARE BLEU	STICKER FRONT LIGTH BLUE	ADHESIVO PLACA FARO AZUL
17	1	H288	H288	ADHESIF GB AV GRIS	STICKER FRONT MUDGUARD GREY	ADHESIVO GB DELANTERO GRIS
18	1	H291	H291	ADHESIF PLAQUE PHARE GRIS	STICKER FRONT LIGHT GREY	ADHESIVO PLACA FARO GRIS
19	1	H287	H287	ADHESIF GB AV ROUGE	STICKER FRONT MUDGUARD RED	ADHESIVO GB DELANTERO ROJO
20	1	H290	H290	ADHESIF PLAQUE PHARE ROUGE	STICKER FRONT LIGHT RED	ADHESIVO PLACA FARO ROJO

POS	QTS	50 SM	50 END	FRANCAIS	ANGLAIS	ESPAGNOL
1	1	H230	H230	SELLE GRISE	GREY SEAT	SILLIN GRIS
2	1	H224	H224	SELLE ROUGE	RED SEAT	SILLIN ROJO
3	1	H062	H062	SELLE BLEU	BLUE SEAT	SILLIN AZUL

POS	QTS	50 SM	50 END	FRANCAIS	ANGLAIS	ESPAGNOL
15	1	Y021	Y021	CARBURATEUR SHA 14-12 MR 2234	CARBURETOR	CARBURADOR
19	1	Y023	Y023	CYLINDRE D40.3 112 RAF LIQUIDE	CYLINDER	CILINDRO
62	1	Y185	Y185	PISTON D 40.3	PISTON	PISTON
77	1	Y202	Y202	CULASSE	HEAD CYLINDER	CULATA
82	1	Y207	Y207	ALLUMAGE DUCATI	CDI MAGNETO ASSY	ENCENDIDO COMPLETO
99	1	Y017	Y017	BARRILLET VITESSE	SHIFT CAM	TAMBOR DE SELECTION
111	1	Y018	Y018	BOUGIE NGK BR9 ES	PLUG SPARK	BUJIA
212	1	Y025	Y025	COUVERCLE CARTER EMBRAYAGE	COVER CLUTCH SIDE	TAPA CARTER
213	1	Y026	Y026	COUVERCLE PPE HUILE	COVER OIL PUMP	TAPA BOMBA ACEITE
214	1	Y027	Y027	COUVERCLE CARTER ALLUMAGE	COVER FLYWEEL SIDE	TAPA CARTER ENCENDIRO
332	1	Y044	Y044	FOURCHETTE AXE SELECTEUR	FORK SHAFT AXLE	HORQUINA EJE SELECTOR
333	1	Y041	Y041	FOURCHETTE	FORK	HORQUINA
334	1	Y042	Y042	FOURCHETTE	FORK	HORQUINA
335	1	Y043	Y043	FOURCHETTE	FORK	HORQUINA
381	1	Y048	Y048	EMBIELLAGE COMPLET	CRANKSHAFT ASSY	CONJUNTO CIGUENAL
382	1	Y049	Y049	KIT BIELLE	KIT CONNECTING ROD	KIT BIELA
435	1	Y070	Y070	LEVIER EMBRAYAGE	PUSH LEVER ASSY	LEJA EMBRAGUE
471	1	Y080	Y080	MOYEU RESSORT KICK	SPRING TORSION HUB	GUIA MUELLE ARRANQUE
606	1	Y184	Y184	PIPE ADMISSION	MANIFOLD	TOBERA ADMISION
641	1	Y186	Y186	PPE HUILE DELLORTO PLBD38	OIL PUMP	BOMBA ACEITE
657	1	Y188	Y188	TENDEUR CABLE PPE HUILE	HOLDER	SENSOR CABLE
658	1	Y187	Y187	ARRET CABLE EMBRAYAGE	HOLDER	TOPE CABLE EMBRAGUE
681	1	Y196	Y196	SEGMENT D 40.3*1;2	PISTON RING SET STD	ARO
701	1	Y189	Y189	CARTER MOTEUR	CRANKCASE ASSY	CARTER MOTOR
911	1	Y002	Y002	ARBRE PRIMAIRE	AXLE MAIN	EJE PRIMARIO
912	1	Y001	Y001	ARBRE DE KICK NU	KICK STARTER SHAFT	EJE ARRANQUE
914	1	Y003	Y003	ARBRE SECONDAIRE	AXLE DRIVE	EJE SEGUNDARIO
915	1	Y004	Y004	ARBRE SELECTEUR	SHIFT SHAFT	EJE SELECTOR
917	1	Y005	Y005	BALANCIER	WEIGHT	EJE DE EQUILIBRADO

POS	QTS	50 SM	50 END	FRANCAIS	ANGLAIS	ESPAGNOL
2430	1	Y030	Y030	PASSE CABLE PPE HUILE	RUBBER	PASA CABLES
2467	1	Y032	Y032	RACCORD SORTIE PPE EAU	JT HOSE 2	RACORD SALIDA POMPA AGUA
2472	1	Y033	Y033	STUFFER ACCELERATEUR AIR	STUFFER	ESTARTER
2478	1	Y031	Y031	PASSE FIL PPE HUILE	RUBBER	PASA CABLES
2492	1	Y038	Y038	BOUCHON REMPLISSAGE HUILE	PLUG OIL	TAPON LLENARO ACEITE
2495	1	Y034	Y034	TUBE SORTIE HUILE L 190	HOSE OIL	TUBO SALIDA ACEITE
2496	1	Y035	Y035	TUBE ENTREE HUILE L 345	HOSE OIL	TUBO ENTRADA ACEITE
3511	1	Y046	Y046	PLAQUE PRESSION EMBRAYAGE	PRESSURE PLATE	PLACA PRESION EMBRAGUE
3540	3	Y045	Y045	DISQUE EMBRAYAGE LISSE	PLATE CLUTCH	DISCO LISO
3551	4	Y047	Y047	DISQUE EMBRAYAGE GARNI	FRICITION PLATE	DISCO FERRADO
4001	1	Y068	Y068	CLOCHE EMBRAYAGE AV PIGNNON	DRIVEN GEAR ASSY	CAMPANA EMBRAGUE CON PINON
4017	1	Y069	Y069	NOIX EMBRAYAGE	BOSS CLUTCH	MAZA EMBRAGUE
4022	1	Y050	Y050	PIGNON SECONDE	GEAR 2ND PINION	PINON 2
4023	1	Y051	Y051	PIGNON TROISIEME QUATRIEME	GEAR 3RD/4TH PINION	PINON 3/4
4025	1	Y052	Y052	PIGNON CINQUIEME	GEAR 5TH PINION	PINON 5
4026	1	Y053	Y053	PIGNON SIXIEME	GEAR 6TH PINION	PINON 6
4031	1	Y054	Y054	PIGNON PREMIERE	GEAR 1ST WEEL	PINON 1
4032	1	Y055	Y055	PIGNON DEUXIEME	GEAR 2ND WEEL	PINON 2
4033	1	Y056	Y056	PIGNON TROISIEME	GEAR 3RD WEEL	PINON 3
4034	1	Y057	Y057	PIGNON QUATRIEME	GEAR 4 TH WEEL	PINON 4
4035	1	Y058	Y058	PIGNON CINQUIEME	GEAR 5TH WEEL	PINON 5
4036	1	Y059	Y059	PIGNON SIXIEME	GEAR 6 TH WEEL	PINON 6
4040	1	Y060	Y060	PIGNON INTERMEDIAIRE	IDLE GEAR	PINON INTERMEDIO
4045	1	Y061	Y061	PIGNON ARBRE DE KICK	STARTING GEAR	PINON EJE ARRANQUE
4048	1	Y065	Y065	PIGNON PPE	GEAR IMPELLER SHAFT	PINON BOMBA
4049	1	Y064	Y064	PIGNON PPE HUILE	PUMP DRIVER GEAR	PINON BOMBA ACEITE
4060	1	Y062	Y062	PIGNON ENTRAINEMENT BALANCIER	GEAR DRIVE	PINON ENTRONQUE EQUILIBRADO
4061	1	Y063	Y063	PIGNON ENTRAINEMENT BALANLIER	GEAR BALANCE WEIGHT	PINON ENTRONQUE EQUILIBRADO
4066	1	Y066	Y066	PIGNON FOU ARBRE DE KICK	STARTING SLIDING	PINON LOCO EJE ARRANQUE

POS	QTS	50 SM	50 END	FRANCAIS	ANGLAIS	ESPAGNOL
4620	4	Y072	Y072	RESSORT EMBRAYAGE	SPRING COMPRESSION	MUELLE EMBRAGUE
4625	1	Y073	Y073	RESSORT PIGNON FOU ARB KICK	SPRING	MUELLE PINON LOCO ARRANQUE
4635	1	Y079	Y079	RESSORT BILLE BARILLET	SPRING	MUELLE BOLA TAMBOR
4650	1	Y074	Y074	RESSORT RAPPEL FOURCH SELECT	SPRING	MUELLE MORQUILLA
4655	1	Y075	Y075	RESSORT RAPPEL AXE SELECT	SPRING	MUELLE EJE SELECTOR
4660	1	Y076	Y076	RESSORT RAP CDT EMBRAYAGE	SPRING TORSION	MUELLE LEVA EMBRAGUE
4665	1	Y077	Y077	RESSORT RAPPEL KICK	SPRING	MUELLE ARRANQUE
4680	1	Y078	Y078	RONDELLE RESSORT	WASHER CONICAL SPRING	ARENDELA MUELLE
5101	2	Y133	Y133	CAGE AIGUILLE	NEEDLE BEARING	JAULA AGUJAS
5106	1	Y134	Y134	BAGUE GUIDE RESSORT SELECT	BUSH SOLID	GUID MUELLE
5113	1	Y140	Y140	CAGE AIGUILLE PISTON	NEEDLE BEARING	COJINETE AGUJAS PISTON
5146	1	Y135	Y135	RLT ARBRE BALANCIER G	BEARING	RODAMIENTO
5148	1	Y136	Y136	RLT ARBRE PRIMAIRE	BEARING	RODAMIENTO EJE PRIMARIO
5156	1	Y137	Y137	RLT ARBRE SECONDAIRE	BEARING	RODAMIENTO EJE SECUNDARIO
5172	1	Y138	Y138	RLT D BALANCIER	BEARING	RODAMIENTO EJE BALANCE
5178	2	Y139	Y139	RLT VILLO	BEARING	RODAMIENTO CIGUENAL
5181	1	Y141	Y141	BILLE TIGE EMBRAYAGE	BALL	BOLA VARILLA EMBRAGUE
5182	1	Y142	Y142	BILLE BARILLET VITESSE	BALL	BOLA TAMBOR SELECTOR
5303	2	Y143	Y143	JOINT TORIQUE	O RING	TORICA
5308	1	Y144	Y144	JOINT TORIQUE	O RING	TORICA
5310	1	Y145	Y145	JOINT TORIQUE ECHAPPEMENT	O RING	TORICA
5315	1	Y146	Y146	JOINT TORIQUE	O RING	TORICA
5318	1	Y147	Y147	JOINT TORIQUE	O RING	TORICA
5320	1	Y164	Y164	JOINT EMBASE	OIL SEAL	JUNTA CILINDRO
5327	1	Y151	Y151	JT CARTER EMBASE	GASKET CRANKCASE COVER	JUNTA
5341	1	Y152	Y152	JT CARTER PPE EAU	GASKET HOUSING COVER	JUNTA BOMBA DE AGUA
5357	1	Y153	Y153	JOINT	GASKET	JUNTA
5358	1	Y154	Y154	JOINT	GASKET	JUNTA
5359	3	Y155	Y155	JOINT	GASKET	JUNTA

POS	QTS	50 SM	50 END	FRANCAIS	ANGLAIS	ESPAGNOL
5361	1	Y156	Y156	JOINT	GASKET	JUNTA
5362	1	Y157	Y157	JOINT	GASKET	JUNTA
5371	1	Y158	Y158	JOINT SPI	OIL SEAL	RETEN
5372	1	Y159	Y159	JT SPI CDT EMBRAYAGE	OIL SEAL	RETEN EMBRAGUE
5376	1	Y160	Y160	JT SPI VILLO	OIL SEAL	RETEN CIGUENAL
5395	1	Y161	Y161	JT SPI PPE EAU	OIL SEAL	RETEN BOMBA DE AGUA
5398	1	Y162	Y162	JT VILLO D	OIL SEAL	RETEN CIGUENAL D
5603	1	Y165	Y165	TURBINE PPE EAU	IMPELLER SHAFT ASSY	TURBINA BOMBA DE AGUA
5605	1	Y166	Y166	TIGE EMBRAYAGE	ROD PUSH	VARILLA EMBRAGUE
5611	1	Y168	Y168	BUTEE BILLE BARILLET SELECT	PIN RETAINER	TOPE BOLA BARRIETE SELECTOR
5612	1	Y167	Y167	THERMOSTAT	THERMOSTAT ASSY	TERMOSTATO
5615	2	Y169	Y169	PION CENTRAGE CARTER INT	PIN DOWEL	CASQUILLO CENTRAJE CARTER
5616	2	Y170	Y170	PION CENTRAGE CARTER EMB	PIN DOWEL	CASQUILLO CENTRAJE CARTER EMBRA
5636	1	Y176	Y176	AXE FOURCHETTE	PIN	EJE HORQUILLA
5637	1	Y177	Y177	AXE FOURCHETTE	PIN	EJE HORQUILLA
5645	1	Y171	Y171	CONTACTEUR POINT MORT	NEUTRAL SWITCH ASSY	CONTACTOR PUNTO MUERTO
5650	1	Y178	Y178	AXE PPE HUILE	PIN	EJE BOMBA ACEITE
5653	1	Y179	Y179	AXE	PIN	EJE
5661	1	Y172	Y172	CLAVETTE AXE PPE HUILE	WOODRUFF KEY	CHAVETA EJE BOMA ACEITE
5663	2	Y173	Y173	PION CENTRAGE PPE	PIN DOWEL	CASQUILLE CENTRAJE BOMBA
5665	1	Y174	Y174	TIGE POUSSE EMBRAYAGE	ROD PUSH	TIJA PULSAROR EMBRAGUE
5670	1	Y175	Y175	AXE PISTON	PISTON PIN	BULON PISTON
6013	1	Y181	Y181	CARTER PPE EAU	COVER HOUSING	CARTER BOMBA AGUA
6015	1	Y180	Y180	BOITE CLAPET	REED VALVE ASSY	CAJA DE LAMINAS COMPLETA
9323	2	Y009	Y009	CLIP PISTON	STOP RING	CIRCLIP PISTON
9351	3	Y010	Y010	CIRCLIPS ARBRE D8	CIRCLIP	CIRCLIP ARBOL
9352	2	Y011	Y011	CIRCLIPS ARBRE D12	CIRCLIP	CIRCLIP ARBOL
9355	3	Y012	Y012	CIRCLIPS ARBRE D 18	CIRCLIP	CIRCLIP ARBOL
9356	1	Y013	Y013	CIRCLIPS ARBRE D 18	CIRCLIP	CIRCLIP ARBOL

POS	QTS	50 SM	50 END	FRANCAIS	ANGLAIS	ESPAGNOL
9362	3	Y014	Y014	CIRCLIPS ARBRE D 20	CIRCLIP	CIRCLIP ARBOL
9363	2	Y015	Y015	CIRCLIPS ARBRE D 14	CIRCLIP	CIRCLIP ARBOL
9365	3	Y016	Y016	CIRCLIPS ARBRE D 20	CIRCLIP	CIRCLIP ARBOL
15270	1	Y019	Y019	RACCORD MISE A L AIR LIBRE	OIL BREATHER PIPE	DEPRESOR
15320	1	Y020	Y020	DERIVATION TUYAU HUILE	DEVIATING PIPE	DERIVACION TUBO ACEITE
49004	2	Y083	Y083	CLIPS TUBE PPE HUILE	CLAMP	CLIP
49007	2	Y082	Y082	CLIPS FIX DURITE	CLAMP	CLIP FIJO
49009	1	Y085	Y085	CLAVETTE PIGNON BALANCIER	KEY	CHAVETA PINON EJE BALANCE
49010	1	Y086	Y086	CLAVETTE PIGNON VILLO	KEY	CHAVETA PINON CIGUENAL
49015	1	Y087	Y087	CLAVETTE VOLANT ALLUMAGE	KEY	CHAVETA VOLANTE ENCENDIRO
49035	1	Y088	Y088	ECROU	NUT HEXAGON	TUERCA
49037	4	Y094	Y094	ECROU AUTOBLOCK	NUT CAP	TUERCA AUTOBLOCK
49040	1	Y093	Y093	ECROU	NUT HEXAGON	TUERCA
49041	1	Y090	Y090	ECROU H=7 CH 17	NUT HEXAGON	TUERCA
49042	1	Y089	Y089	ECROU	NUT HEXAGON	TUERCA
49049	1	Y091	Y091	ECROU H=5 CH 19	NUT HEXAGON	TUERCA
49056	1	Y092	Y092	ECROU H=11 CH 17	NUT	TUERCA
49068	1	Y095	Y095	ENTRETOISE	FORK SPACER	CASQUILLO
49070	1	Y097	Y097	ENTRETOISE VILLO	SPACER	CASQUILLO CIGUENAL
49074	1	Y096	Y096	ENTRETOISE CLOCHE/NOIX EMBRAY	PLATE THRUST	CASQUILLO CAMPANA
49084	4	Y098	Y098	GOUJON CYLINDRE	BOLT STUD	ESPARRAGO CYLINDRO
49095	4	Y099	Y099	RONDELLE CULASSE	WASHER PLAIN	ARANDELA CULATA
49101	1	Y100	Y100	RONDELLE EVENTAIL	WASHER TOOTHED LOCK	ARANDELA
49120	2	Y101	Y101	RONDELLE	WASHER	ARANDELA
49122	1	Y102	Y102	RONDELLE	WASHER	ARANDELA
49124	2	Y103	Y103	RONDELLE	WASHER	ARANDELA
49131	1	Y104	Y104	RONDELLE	WASHER	ARANDELA
49132	1	Y105	Y105	RONDELLE	WASHER THRUST	ARANDELA
49135	2	Y106	Y106	RONDELLE	WASHER	ARANDELA

POS	QTS	50 SM	50 END	FRANCAIS	ANGLAIS	ESPAGNOL
49139	2	Y125	Y125	RONDELLE	WASHER	ARANDELA
49151	3	Y126	Y126	RONDELLE	WASHER	ARENDELA
49155	3	Y127	Y127	RONDELLE	WASHER	ARENDELA
49175	1	Y107	Y107	RONDELLE	WASHER	ARANDELA
49191	4	Y108	Y108	RONDELLE	WASHER	ARANDELA
49192	1	Y109	Y109	RONDELLE	WASHER LOCK	ARANDELA
49193	1	Y110	Y110	RONDELLE	WASHER PLATE	ARANDELA
49200	1	Y111	Y111	VIS	SCREW	TORNILLO
49226	3	Y124	Y124	VIS TBEI	SCREW TBEI	TORNILLO TBEI
49227	2	Y112	Y112	VIS	SCREW	TORNILLO
49228	4	Y129	Y129	VIS CLOCHE EMBRAYAGE	SCREW	TORNILLO
49230	2	Y113	Y113	VIS TCB	SCREW TCB	TORNILLO TCB
49236	2	Y114	Y114	VIS BTR	SCREW BTR	TORNILLO BTR
49238	5	Y115	Y115	VIS BTR	SCREW BTR	TORNILLO BTR
49244	4	Y131	Y131	VIS BTR	SCREW BTR	TORNILLO BTR
49245	2	Y116	Y116	VIS BTR	SCREW BTR	TORNILLO BTR
49246	7	Y117	Y117	VIS BTR	SCREW BTR	TORNILLO BTR
49248	13	Y118	Y118	VIS BTR	SCREW BTR	TORNILLO BTR
49251	1	Y119	Y119	VIS BTR	SCREW BTR	TORNILLO BTR
49255	1	Y120	Y120	VIS BTR	SCREW BTR	TORNILLO BTR
49281	1	Y121	Y121	VIS TH	SCREW HEXAGON HEAD	TORNILLO TH
49290	1	Y122	Y122	VIS TH	SCREW HEXAGON HEAD	TORNILLO TH
49294	1	Y123	Y123	VIS TH	SCREW HEXAGON HEAD	TORNILLO TH
53508	1	Y163	Y163	JT SPI ARBRE SECONDAIRE	OIL SEAL	RETEN EJE SECUNDARIO
	1	Y006	Y006	ARBRE PRIMAIRE CPLT	AXLE MAIN ASSY	CONJUNTO EJE PRIMARIO
		Y007	Y007	ARBRE SECONDAIRE CPLT	AXLE DRIVE ASSY	CONJUNTO EJE SECUDARIO
		Y008	Y008	ARBRE SELECTEUR CPLT	SHIFT SHAT ASSY	EJE SELECTOR COMPLETO

The background of the advertisement features a blue and purple gradient with a wavy, wood-grain-like texture. Two motorcyclists in full gear are depicted in a dynamic, forward-leaning pose, appearing to be in motion. The Sherco logo is prominently displayed in the center, with a white lightning-bolt graphic element behind it. The IPONE logo is positioned below the main text, and the website URL is centered at the bottom. The contact information is located at the very bottom of the page.

SHERCO

Motorcycles

 **IPONE**

www.sherco-moto.com

SHERCO S.A.R.L. <information@sherco-moto.com> Fax : +34 93 865 56 91